

sunsation™
RETRACTABLE AWNINGS

installationguide

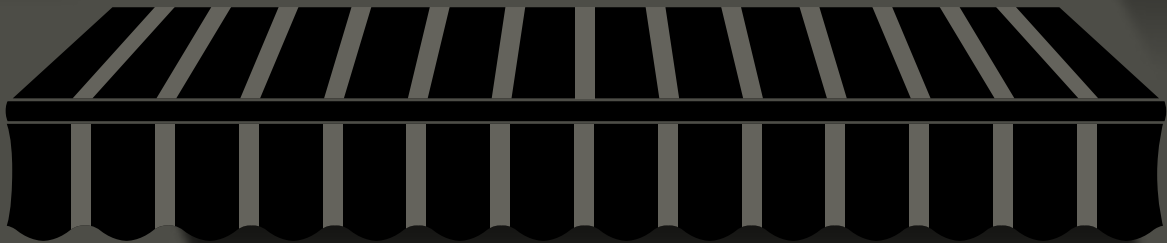

INSTALL

SUN 3000 • 5000 • 8000
RETRACTABLE AWNING

Table of contents

Tools needed	3
Mounting & installation.....	4-8
Pitch adjustments	9-10
Arm alignment.....	11
Replace gearbox (Somfy Motor).....	12
Component specifications	13
Wide awning options.....	14-15
Wiring	16-17
Set the awning limit.....	18-19
Support brace.....	20-21
Part numbers	22-26
Taking care of the awning.....	27
Warranty	28

Tools needed for assembly and installation

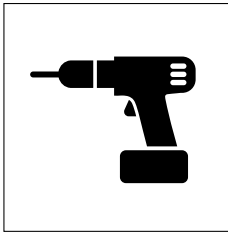

Drill

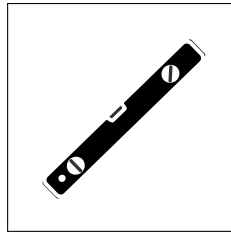

Level

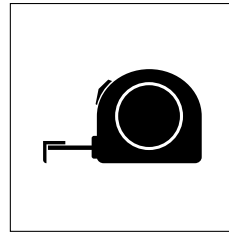

Tape Measure

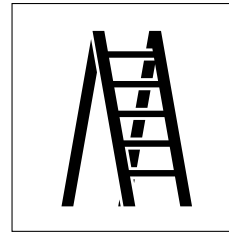

Step-ladder

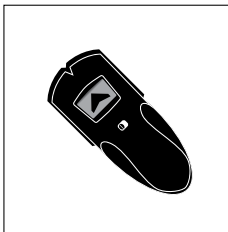

Stud finder

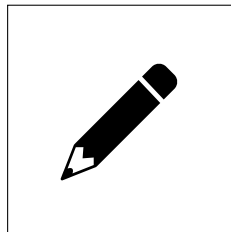

Pencil/Marker

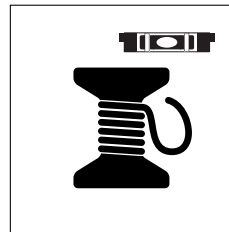

Rope line and rope line level

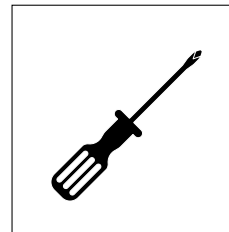

Phillips screwdriver

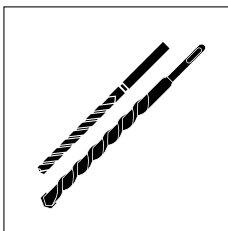

5/8" Masonry bit
(for brick and concrete),
or 1/4" high-speed bit
(for wood)

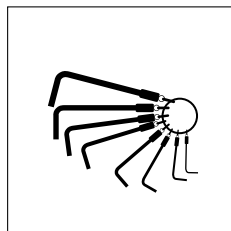

Metric allen wrench

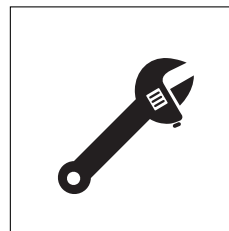

Adjustable Wrench

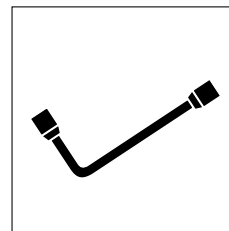

9/16" sockets

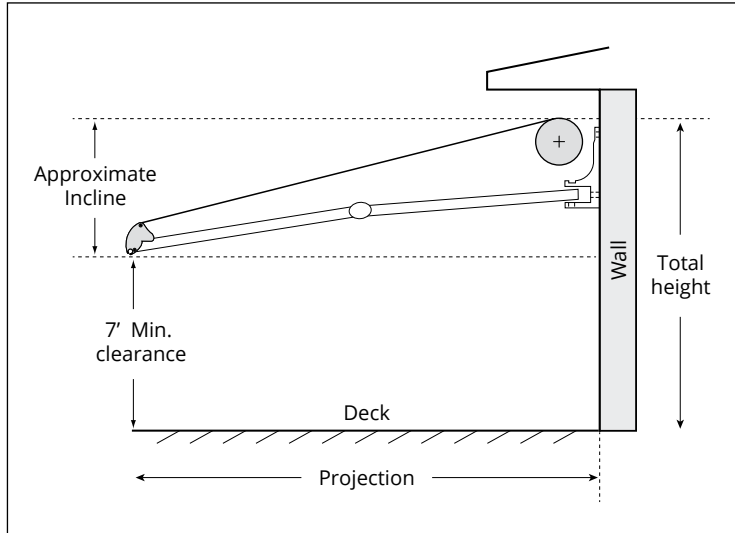

Projection	Approx Incline	Total Height
3' 3"	10"	7' 10"
5'	15"	8' 3"
5' 9"	18"	8' 6"
6' 6"	20"	8' 8"
8' 2"	24"	9'
9'	27"	9' 3"
9' 10"	30"	9' 6"
11' 6"	35"	9' 11"

Mounting Height

To assure head clearance at the front of the awning, we recommend the front profile to be above 7 foot from the deck/patio.

For each foot that the awning projects out from the wall, raise the wall installation by 3".
 For e.g. if the awning projection is 5 feet the installation height should be 7 feet plus 15 inches, a total height of 8 feet and 3 inches.

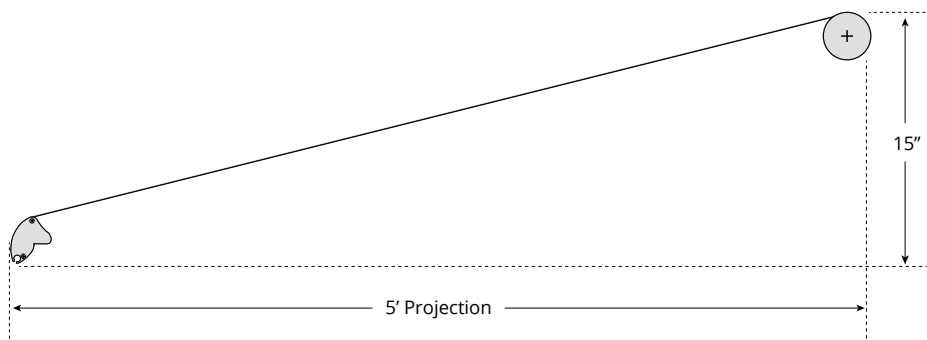

Note: When making the decision on the mounting height, remember that the awning requires 8 inches of unobstructed area along the whole length of the awning to fit the mounting brackets on your wall, 9 inches of unobstructed area along the wall needed if mounting with a hood.

Surface Preparation

Proper location of the brackets is the most important aspect of the awning mounting. They must be fastened to studs, joists, headers or other major structural members. Even a moderate wind exerts great force on the awning and mounting brackets. This is why it is most important that all awning mounting brackets be fastened properly and securely. Proper location will also make it easier to insert the support tube when hanging the awning.



Warning: failure to securely fasten all the brackets to the wall could result in the collapse of the awning and cause personal injury

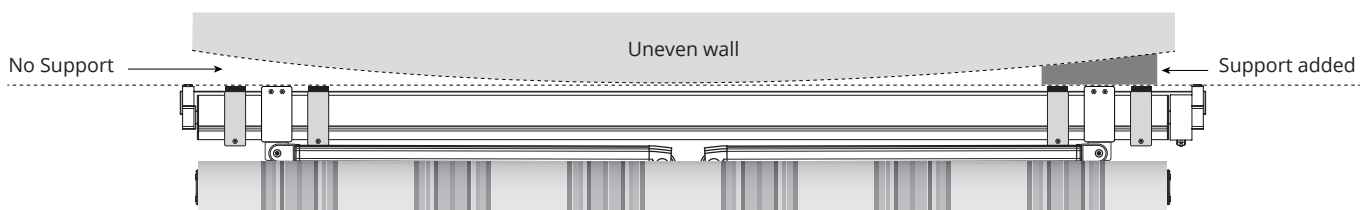

Wall surface

Make sure that the face is structured and not just an unsupported facade. Make sure the wall is flat, by pulling a rope from one side to the other. If the wall is not straight, the brackets will not align properly (Picture above).



Warning: when the wall is not straight, do NOT force/bend the awning to reach the wall, it will go off alignment and wont roll properly.

Soft walls

Shingles, vinyl, aluminum siding, clapboards or stucco walls.

The best way to deal with a soft or unlevelled walls is to mount a 2" x 10" pressure treated board (shim) to the house and fasten the brackets through the board into the header and studs. Longer bolts are needed. This is also recommended for uneven walls.

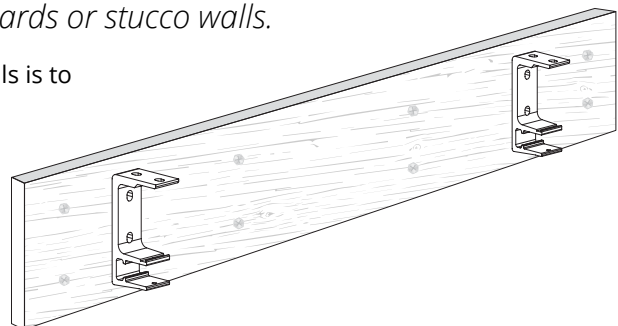

Mounting the Brackets

Position the bracket on the wall (or on the shim), and mark the top and bottom holes.

Remove the bracket and drill the top hole through the siding block or shim (if appropriate) and about 3-1/2" into the stud or joist. Using a 1/4" drill bit. This will prevent the framing from splitting while installing the lag screws. Make sure the bottom hole is plumbed with the top hole, then drill the bottom hole.

Using a 9/16" socket, install the bracket with the two 3/8" x 4" long lag screws. While tightening the lag screws, keep the bracket plumb (use level if needed). Do not over tighten the lag screws; doing so may split the wood framing or weaken the screw.

Brick and concrete

Use a 5/8" Masonry drill bit. Insert 3/8" long lag shield and use 3/8" x 4" long lag screws, or use 3/8" concrete drop anchors.

The masonry fasteners are ONLY to be installed within the main body of a brick, not within 1/2" of an outer edge of the brick. Fasteners are also not suitable for hollow cinder-block type construction or wall surfaces that have deteriorated.

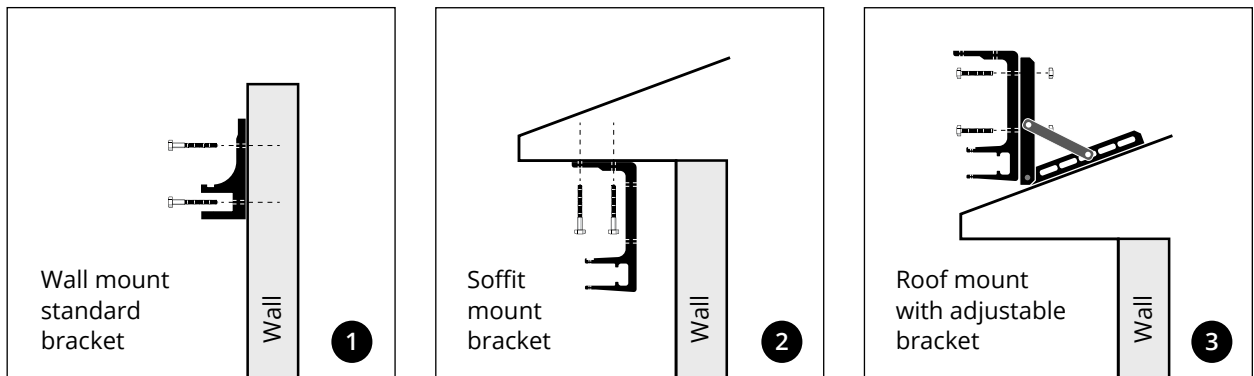

Standard Mounting Brackets

The standard mounting brackets (Picture 1) can only be used for wall and roof mounting.

Hood and Soffit Mount Brackets

These brackets are designed to be used for awnings with a hood and for soffit mounting (Picture 2), it can also be used for regular wall mounting. For roof mounting, an additional adjustable bracket is needed (Picture 3).

Bracket Positioning

For proper alignment, pull a rope line on the wall to other side where the other bracket will be placed, and use a rope line level to make sure it is 100% straight (Picture 1).

Repeat the same process to all brackets.

Two brackets to be placed on both sides of each arm, within 10" of the arm shoulder (Picture 2). The same rule also applies to all other arms (for larger awnings). All other brackets should be spread out equally.

If the awning has a fabric center support, make sure not to locate a wall bracket where it will interfere with the center support. All brackets must be mounted into studs or structural members.

The same rule also applies to Soffit mounting brackets.

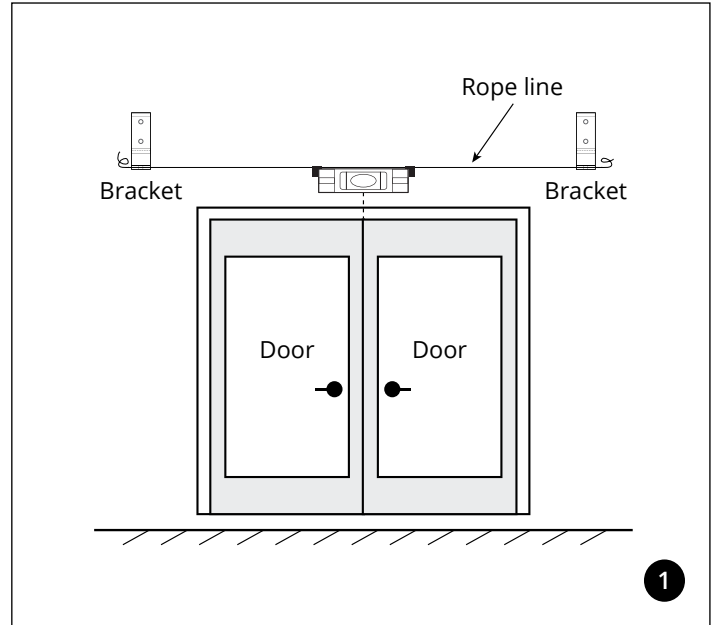

Note: If the awning has a fabric center support, it should be installed on a fabric seam as close to the center of the unit as possible. Adjust the cradle so neither front or back edge touches the fabric as it rolls in and out.

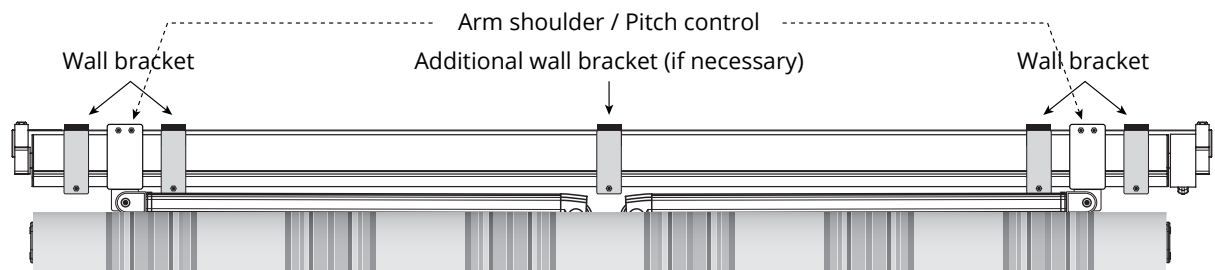

2

Adding the Awning Hood



Note: While Somfy motors are designed for outdoor usage, they are NOT waterproof. An awning with a motor requires a hood to protect the motor from water damage. Awnings without a hood, WILL NOT be eligible for motor warranty repair or replacement.

You will need to install the hood before installing the awning. Insert the 2 provided screws in the plastic, make sure the longer screw is positioned closer to the wall and the shorter screw outwards (Picture 1). Then slide the plastic (with the screws) into the hood raceway.

Proceed with adding the two side covers and fasten it with the provided screws.

Then carefully lower the hood onto the brackets and guide the bolts through the appropriate holes on the brackets. Then, using the supplied nuts and washers, carefully tighten the nuts and attach end covers.

Make sure that the top edge of the hood is flush to the wall (Picture 2), on each bracket, otherwise it may result in a crooked hood (Picture 3) and may eventually damage the fabric.



Note: Improper hood installation may also cause damage to the Awning, fabric and to the motor.

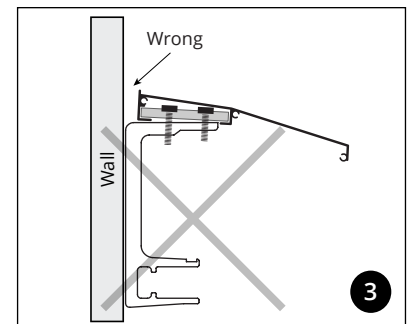
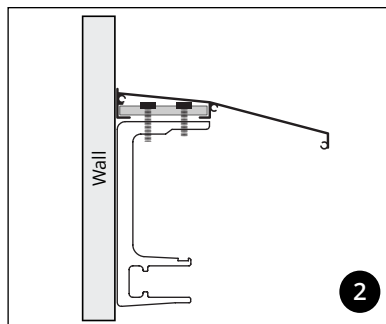
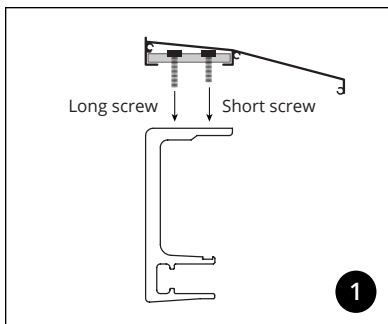

Putting up the awning

Finally you're ready to put up the awning into the brackets. Make sure to tighten all the nuts so the awning is safe. Put white plastic caps over the nut to protect the fabric from scratching.

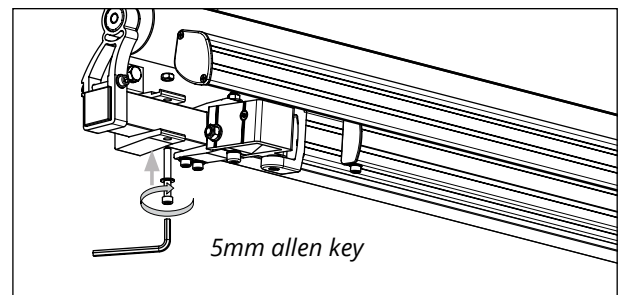

Pitch adjustment (Arm control)

After the awning has been installed, making sure all bolts have been tightened and packing materials removed, extend the awning to its full projection. The folding arms will still be slightly angled. Hold the arm of the awning with one hand or shoulder to remove pressure while doing the adjustment with the other hand.

A level is added to each arm where it is attached to the front profile, this unique addition makes installing your awning easy and accurate within minutes.



Setting the correct pitch is one of the most important details to protect the Awning from rain damage. The more that you pitch the awning, the less water will gather on your awning.

Self-pitch arm control

1. Use the open-end wrench (13 mm) to release the side bolt (Picture 1), **Do NOT unscrew bolts completely.**
2. Use the self-pitch handle to adjust to the desired angle (Picture 2).
3. Use the open-end wrench to **lock the side bolt** (Picture 1).

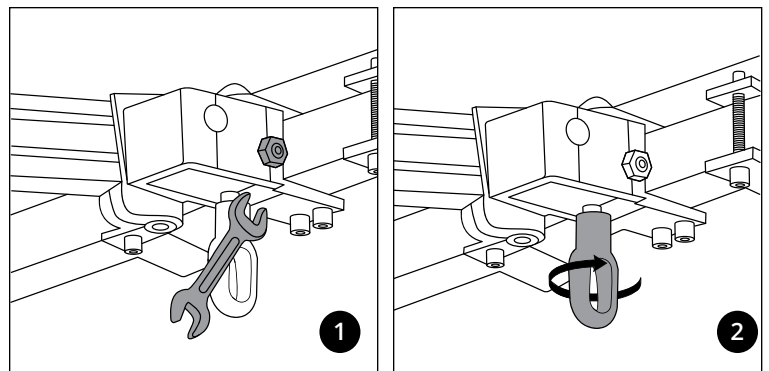

Standard arm control

1. Use the open-end wrench (13 mm) to release the side bolt (Picture 3) **Do NOT unscrew bolts completely.**
2. With the Allen key (6 mm), screw or unscrew the bolt to the desired angle (Picture 4).
3. Use the open-end wrench to **lock the side bolt** (Picture 3).

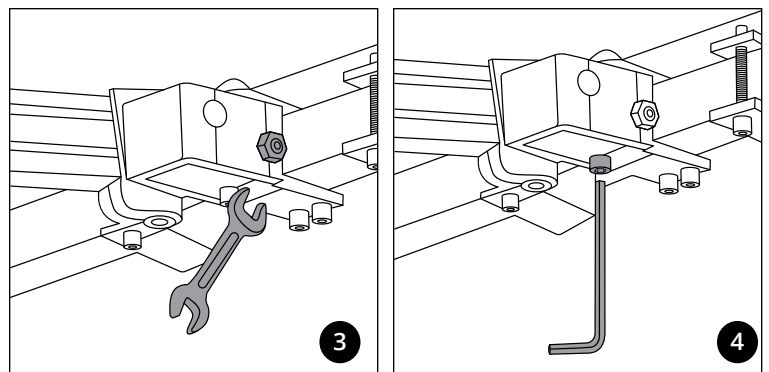

Repeat the same operation on the other side so that the front bar is absolutely leveled.

Large Awnings Pitch adjustment

SUN 4000 Series

1. Use the open-end wrench (23 mm) to release the side bolt (Picture 1), **Do NOT unscrew bolts completely.**
2. You'll need to operate with both screws. Use Allen key (6 mm), screw in one and screw out the other (Picture 2).

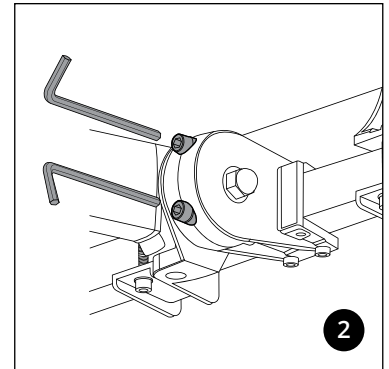
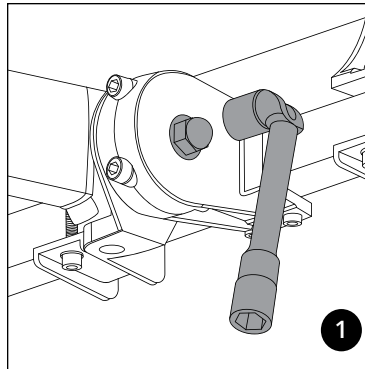

> To **raise** the awning, **unscrew** the **top** screw counterclockwise for a few turns, and **screw in** the **bottom** screw clockwise for a few turns. Then repeat.

> To **lower** the awning, **screw in** (clockwise) the **top** screw, and **unscrew** (counterclockwise) the **bottom** Screw.

3. Use the open-end wrench to **lock the side bolt** (Picture 1).

SUN 5000 Series

1. Use the open-end wrench to release the 2 side bolts (Picture 3), **Do NOT unscrew bolts completely.**
3. With the Allen key, screw or unscrew the bolt to the desired angle (Picture 4).
4. Use the open-end wrench to **lock the 2 side bolts** (Picture 3).

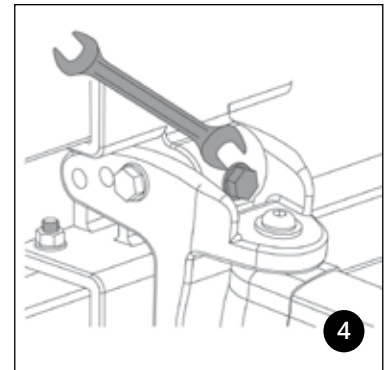
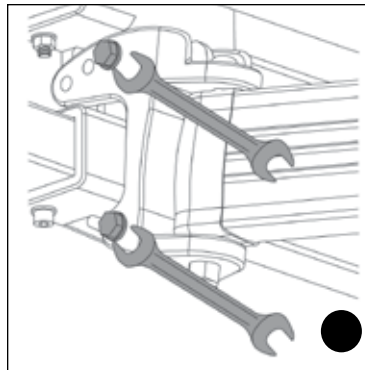

Repeat the same operation on the other side so that the front bar is absolutely leveled.

Arm alignment

Every awning is perfectly aligned and tested before it leaves the Sunsation facility. After installing you will need to check for both arms to be aligned. If they are not aligned, you will need to roll down the awning completely and adjust the fabric. (this is only if the fabric was sewn at Sunsation, otherwise you will need to adjust the arms, which is usually not recommended).

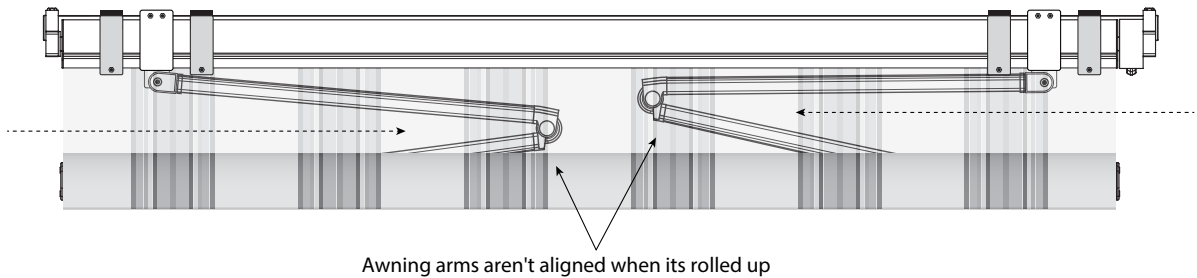

Fabric adjustment

Using example (picture above) when the left arm is outwards

1. Extend the awning to its full projection, continue opening until the roller tube is uncovered
2. Pull and slide the FABRIC on the ROLLER TUBE towards the RIGHT side.
3. Roll up the Awning, the problem should be solved.

The same is for the opposite side. If the right arm is outwards, you'll pull/slide the fabric on the roller tube towards the left side.



Warning: DO NOT screw into the roller tube, it WILL damage the motor and WILL NOT be eligible for motor warranty repair or replacement.

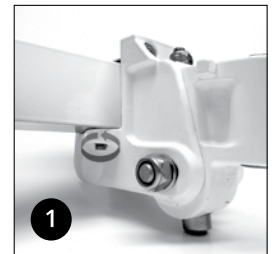

Arm up and down (vertical) adjustment (SUN 3500 cross arm)

If the arms doesn't align vertically, which arms can rub onto each other, you'll need to lift the upper arm, and/or to lower the lower arm.

There are 2 screws on the pitch control, under the square bar (one on the right side and one the left side) (picture 1).

For the lower arm, use the 2 screws on the extension bracket, close to square bar. NOT the screws from the lower bracket (picture 2). Do not overtighten.

To raise the right arm, turn the left screw counterclockwise, and turn the right screw clockwise.

To raise the left arm, turn the right screw counterclockwise, and turn the left screw clockwise.

Note: always turn the counterclockwise first and then turn the clockwise.



How To Replace a Sunsation Awning Gearbox (or Upgrade To a Somfy Motor)

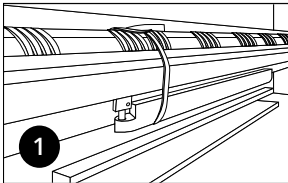

1
Retract the awning and secure it to the square bar with a rope tied around the awning and bar.

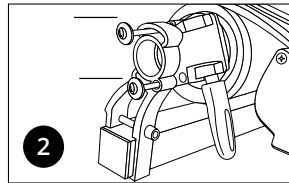

2
Remove the two screws securing the 1442 bracket to the gearbox.

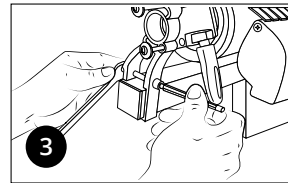

3
Loosen the bolt securing the 1442 bracket to the square bar.

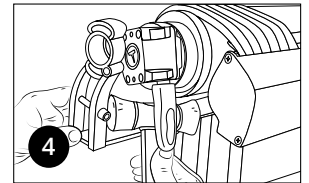

4
Remove the 1442 bracket from the square bar. Use a rubber mallet to dislodge the bracket if necessary.

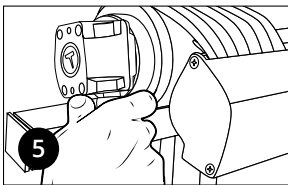

5
Slip the gearbox off the roller tube end cap. If replacing the gearbox, skip to step 12.

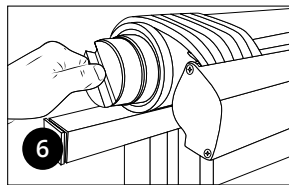

6
Using a flat head screwdriver, pry the end cap off the roller tube.

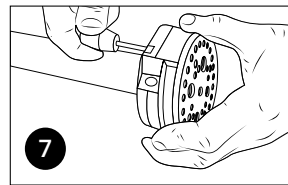

7
Secure motor bracket to motor with screws.

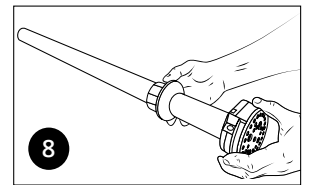

8
Swap out the crown, if necessary, by sliding the existing crown off the tube and replacing with compatible crown.

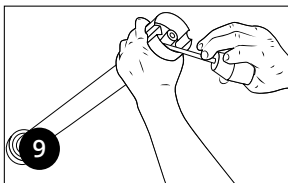

9
Swap out the drive if necessary by prying existing drive off and snapping compatible drive onto motor tube end.

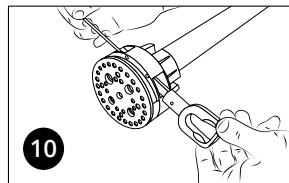

10
Screw the manual override shaft into the motor.

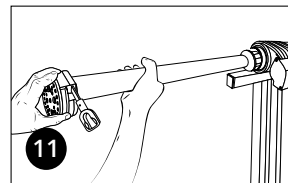

11
Insert the motor assembly into the roller tube.

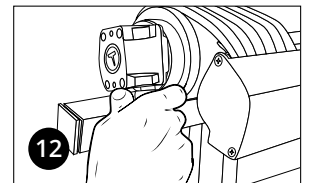

12
(If replacing gearbox, slide new gearbox onto roller tube end cap.)

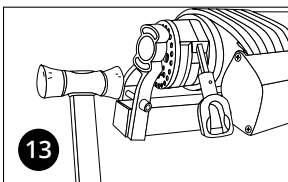

13
Replace the 1442 bracket on the square bar. Secure the 1442 bracket to the motor or gearbox with two screws.

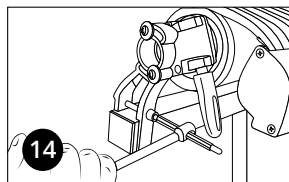

14
Bolt the 1442 bracket to the square bar.

SUN 3000 / 3000 C / 3000 X / 5000 Component Specifications

13



Increase the value and extend the life of your awning fabric with a protective **hood cover** that protects against wind, rain, hail, and other debris.



Arms are made of aluminum extrusion and use twin cables for added strength. These cables are made of stainless steel and covered with PVC, which allows heavier tension and longer outdoor life even at the most extreme outdoor conditions.



The **roller tube** is made of corrosion resistant aluminum. It installs more easily and provides less stress on the bolts and frame - so it lasts longer too!



Reach up to 36' width when using a **center bracket** for extra support. The two connected roller tubes with only a one inch gap. (24' standard max width)



Roller support comes standard with all models 18' or wider to ensure superior strength and durability.



The super-efficient **roller gear** is truly top-of-the-line. That means less strain in both motorized and manually operated models - and many years of trouble-free use!

16' 6" Max Projection
With the 5000 series

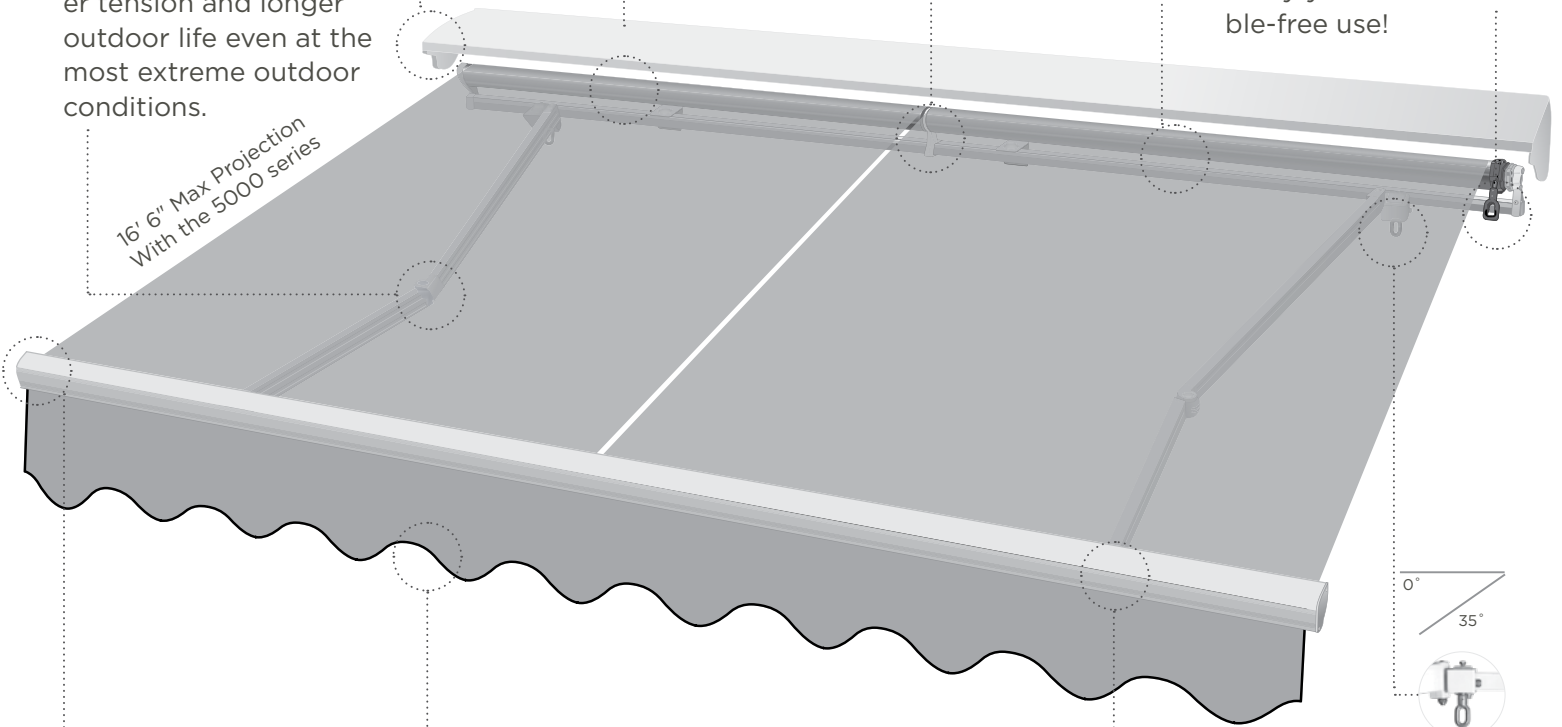

The newly designed front **profile** adds straight, crisp and distinctive style to the overall appearance.



An extensive variety of fabrics, both solid colors and stripes, and many **valence** styles are available.



A **level** is added to each arm where it is attached to the front profile, this unique addition makes installing your awning easy and accurate within minutes.

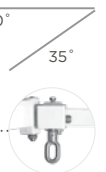

Arm-Pitch Control Made of corrosion resistant aluminum extrusion. Far superior to the industry standard of aluminum die casting. Additionally, with its unique self-pitch feature, homeowners will be able to adjust the self pitch to their desired height by simply cranking the gear at the Pitch Control.

Wide Awnings Split Option

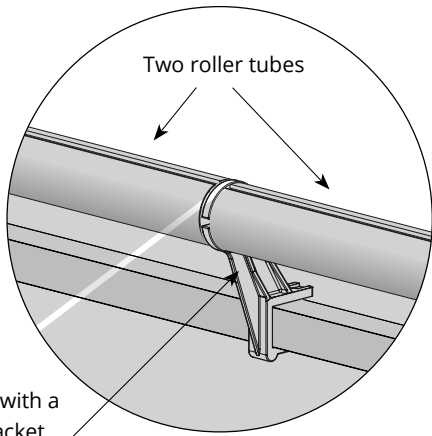
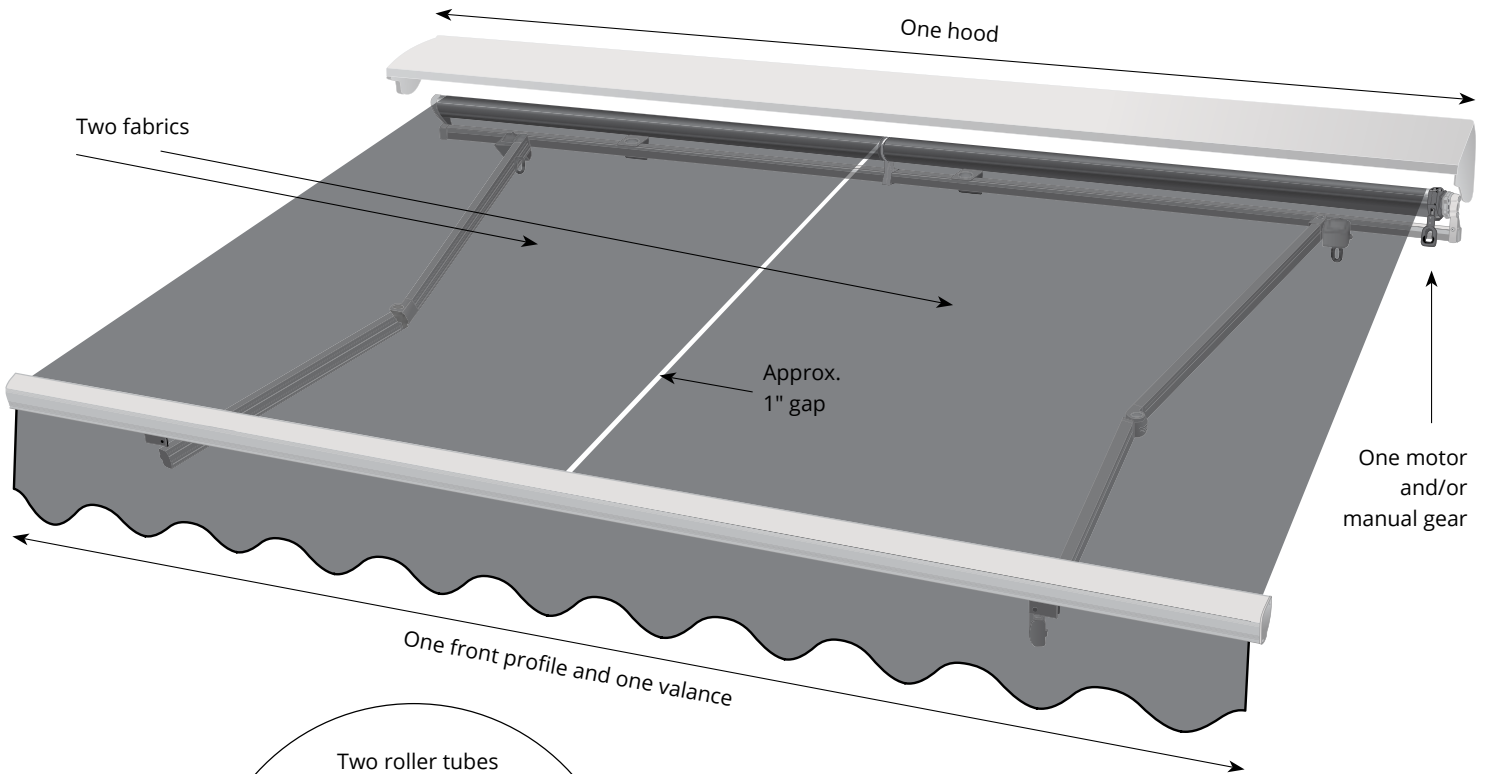

Fabrics on awnings that are greater than 24' wide might sag and cause damage to the fabric and/or structure of the awning. Therefore the fabric can be split in two sections with an approx. 1" gap in-between. It will be on two roller tubes connected with a center bracket providing extra support.

The front profile and valance will be one piece, controlled by one gear/motor.

Installation process is the same as the regular awnings.



Note: large awnings wider then 24' can be split into two, and is highly recommended.

Splice Kit Option

Entering an elevator or shallow staircase with a long awning is not always possible. The awning may be provided (requested by the customer) in two pieces and will need to be assembled at installation location.

The splice kit is a set of components that will enable you to connect the awning profiles and the hood.

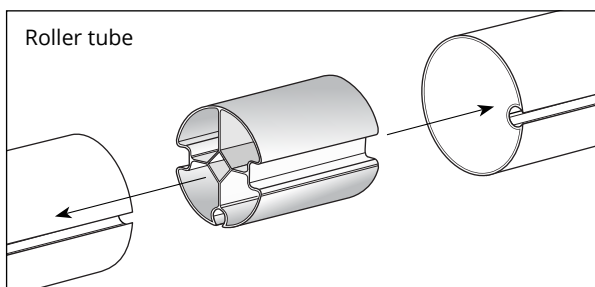

Insert the roller tube connector approx 10" on each side and then fasten it with (SS64) rivets.

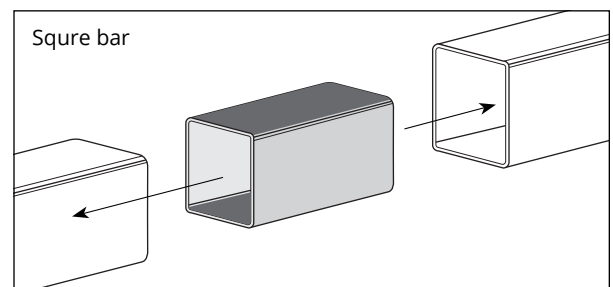

Insert the Square bar connector approx 10" on each side and then fasten it with (SS64) rivets.

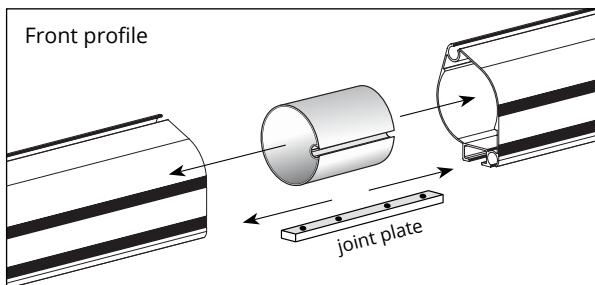

Insert the joint plate and fasten the Allen screws (2 on each side). Insert the roller tube connector approx 10" on each side and then fasten it with (SS64) rivets.

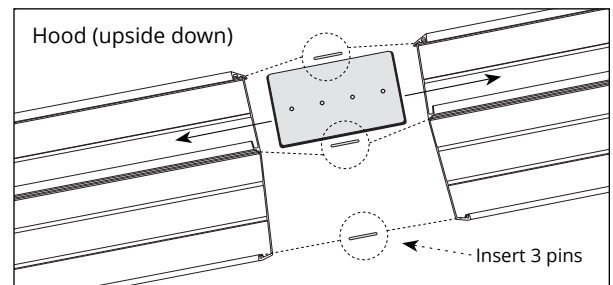

Insert the 3 provided pins, then glide in the joint plate (placed half on each side) and fasten the Allen screws (2 on each side).

You're now ready to insert the fabric to the top roller and the front profile.

Standard CMO motor wiring

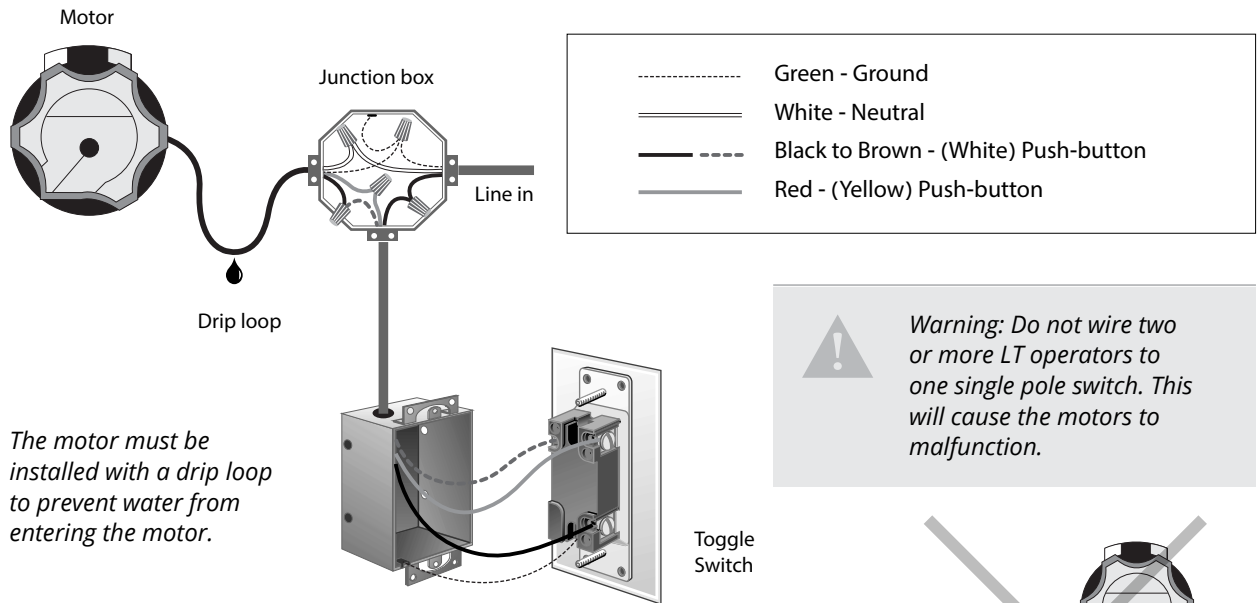

The motor must be installed with a drip loop to prevent water from entering the motor.

Note: While Somfy motors are designed for outdoor usage, they are NOT waterproof. An awning with a motor requires a hood to protect the motor from water damage. Awnings without a hood, WILL NOT be eligible for warranty repair or replacement.

Sunea RTS CMO and Simu motors wiring

It's recommended to have a dedicated powerline for the motor, and should stay powered on. Shutting the motor could cause programing wipeout and other defects.

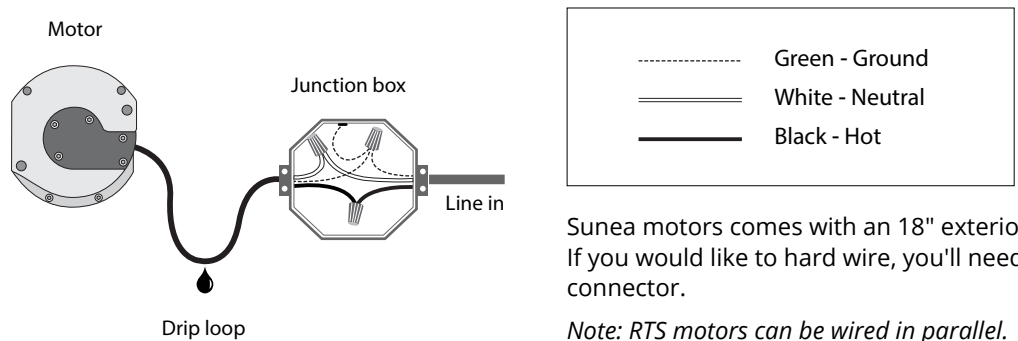

Universal RTS receiver wiring





The Universal Receiver should be mounted as close to the motor as possible. If mounted outside, ensure that the connections are facing down to avoid rain seepage. Avoid mounting the control against any metallic surface, as this may affect radio reception.

Connect high voltage wires according to the wiring diagram on the next page. Make sure to use included watertight strain relief fittings to maintain the weatherproofing of the enclosure.

If used, the RTS sensor should be placed close to the awning or shading system to make sure the wind speed or sun intensity is measured at the product. Guard against installing the wind sensor too close to an obstruction such as a chimney, gutter or the window covering itself, which could block the wind and cause erroneous sensor readings. The sensor should also not be mounted in the shade or be obstructed by trees, to ensure accurate sunlight readings.

WIRING DIAGRAM

COLOR CODE

	BLACK
	RED
	GREEN
	WHITE

CAUTION:

Mount control with fittings facing downward!

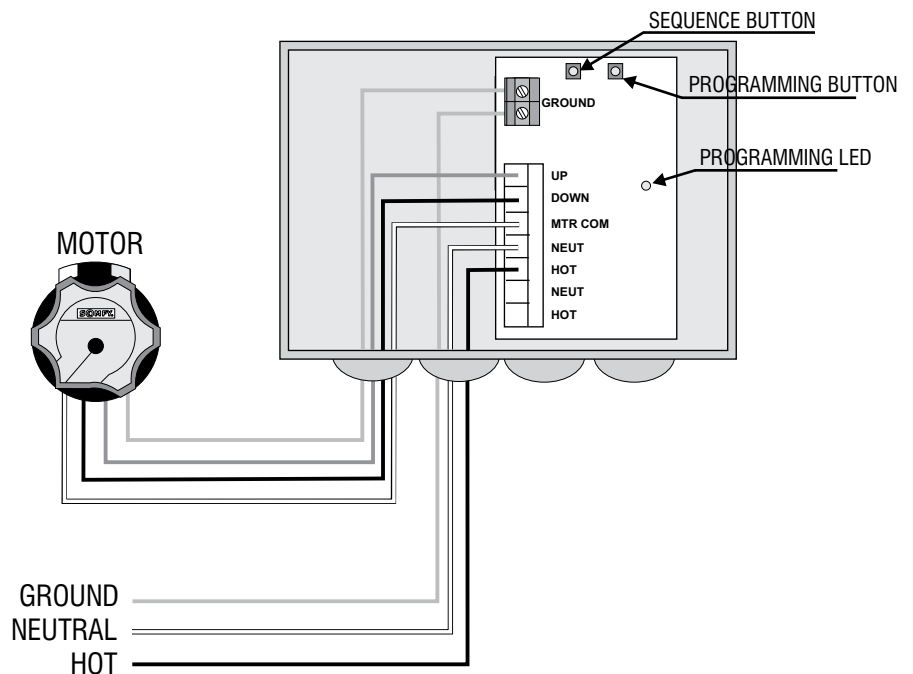

Set the awning limit

Before begin using the awning, the IN and OUT limits need to be set. Failure to set the limits may cause damage to the awning or personal injury.

Every complete awning with fabric, the limits are being set before it leaves the Sunsation facility. Awnings purchased without fabric cannot be set at the Sunsation facility and **MUST** be done after inserting the fabric.

Somfy CMO Motors

Identify the IN limit switch (yellow or white).

If motor is installed on the right side the button closer to the wall is your IN Limit switch and the button further from the wall is your OUTER limit switch.

Press the switch on the wall or on the Transmitter to close the Awning until you reach the desired in position, then stop the motor.

Press and release the in limit switch (Y or W) it will pop up (as in picture 3). IN limit is now set.

Repeat the above operation to set the outer end limit switch (as in picture 4).

Replace the protective cap.

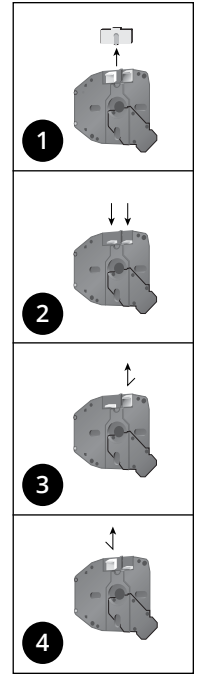

Simu Motors

Identify which limit adjustment screw controls the up limit and which controls the down limit. the arrows by the limits adjustments screws refer to the tube's rotation. Turning the adjustment screw positive (+) will increase the maximum travel in the direction that it controls and turning it negative (-) will decrease the maximum travel.

Run the motor in the selected direction, If the motor stops on its own before reaching the desired stop, turn the appropriate limit screw positive (+). Every 2 or 3 turns of the limit adjustment screw will allow the motor to travel about 1" further. After every few turns of the limit adjustment screw use the control switch to move the motor to the new limit position.

When you are approximately at the desired stop, use the control switch to run the motor away from the limit 2 or 3 feet and then back. This will allow you to see precisely where the limit is set. Make small adjustments and repeat.

If the motor does not stop on its own at least 6 inches before the desired limit position, stop the motor with the control switch. Then turn the adjustment screw in the negative (-) direction.

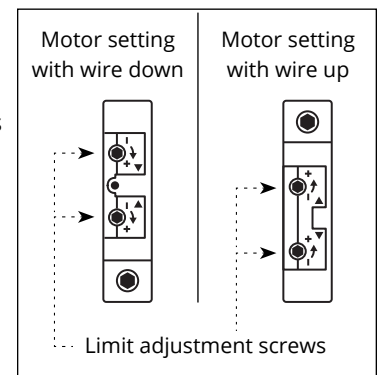

NOTE: The motor has a built-in thermal cut-off. If after several minutes of use the motor will not run in either direction allow the motor to cool approximately 20 minutes.

Set the awning limit remotely

Sunea RTS CMO motors can be set with the Telis remote control.

For videos and Troubleshooting, go to www.sunsationawning.com/support/



STEP 1
Initiate programming by pressing both the ▲ (Up) and ▼ (Down) buttons at the same time until the motor jogs.



STEP 2
Check the direction of operation. Press and hold the ▼ button and confirm it moves the motor out. To change the direction press and hold the Ⓜ (Stop) button until the motor jogs.

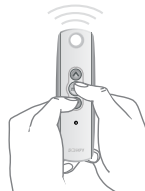

STEP 3
Bring the motor to your desired upper limit by pressing the ▲ button. Press and hold both the Ⓜ and ▼ buttons until the motor begins to move down, then release. Use the Ⓜ button to stop it at the desired lower limit

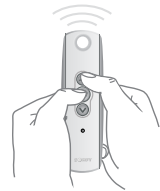

STEP 4
Press the Ⓜ and ▲ button until the motor begins to move up. the motor will stop at the original upper point.



STEP 5
Press and hold the Ⓜ button until the motor jogs



STEP 6
Press and hold the Program button on the back of the transmitter until the motor jogs. Double check limits as a precaution.

Support brace

- A1 Top end of pole brace secured to bottom slot channel of existing front linear aluminum extruded channel.
- A2 Lower end secured to a existing rail or wall.
- B1 Top end of pole brace secured to rear slot channel of existing canopy front linear aluminum extruded channel.
- B2 Lower end secured to an existing ground building surface.
- C During the partial projection of a existing awning canopy the lower end of pole brace may be secured to ground surface or side rail or wall.

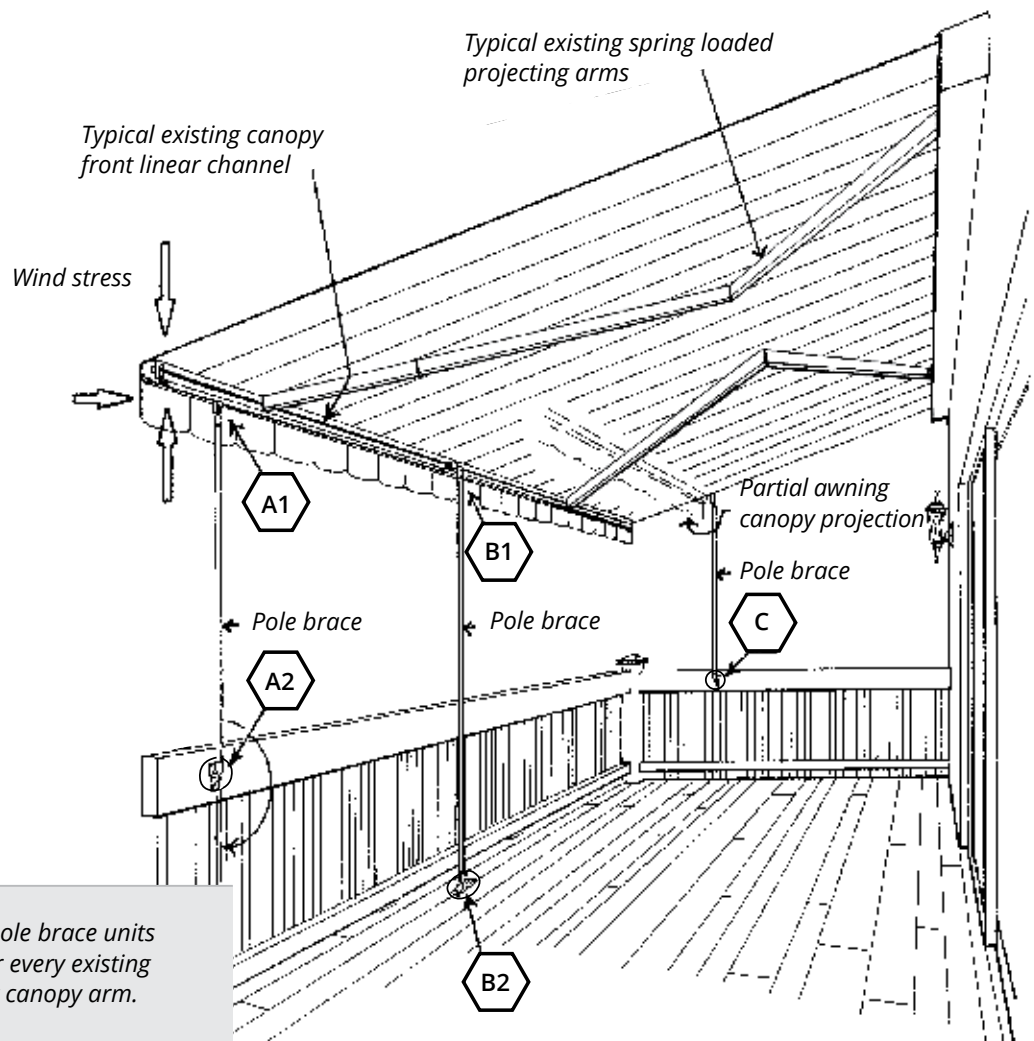

A minimum of 2 pole brace units are required 1 per every existing projecting awning canopy arm.

Support brace

Step 1.

Extend awning to full position and remove plastic end cap from the front profile.

Step 2.

Assemble top bracket (2 lugs & center hole), and Insert into awning channel using appropriate bolts and discard extra's. Typically same as awning arm has been attached to. Attach top sleeve fitting with quick release pin.

Step 3.

Assemble Pole and bottom assembly as follows:

- Insert pole to slip end fitting
- Tighten and pin to bottom bracket
- Place plate into position (arrows parallel to top bar)
- Insert bottom bracket and twist 90°
- Align with top of slip end fitting and cut to size (pipe cutter or hacksaw)
- Insert and tighten

Step 4.

Place a level on pole to suit needs, pole must be 90° or leaning forward to reduce wind shear.

Step 5.

Bolt bottom plate to surface (Optional: Bolt bottom bracket without plate using 2 screws).

Tighten all Screws

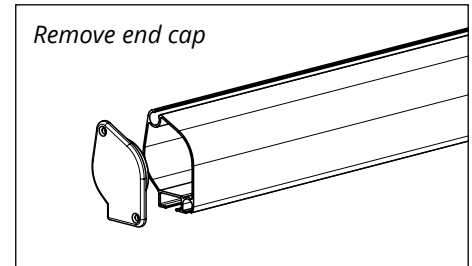

Assemble top bracket

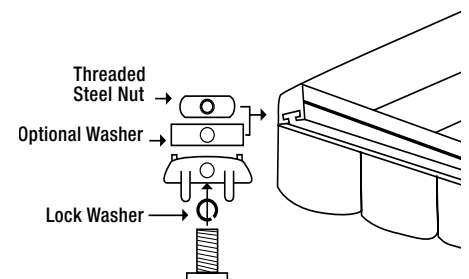

Bottom Assembly

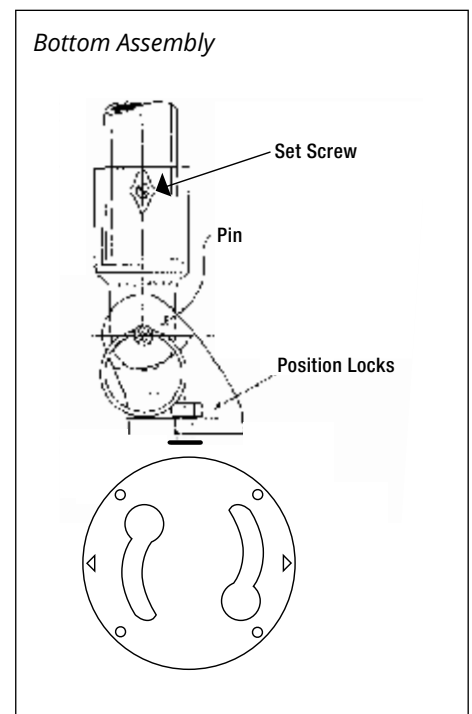

SUN 3000 Replacement Parts

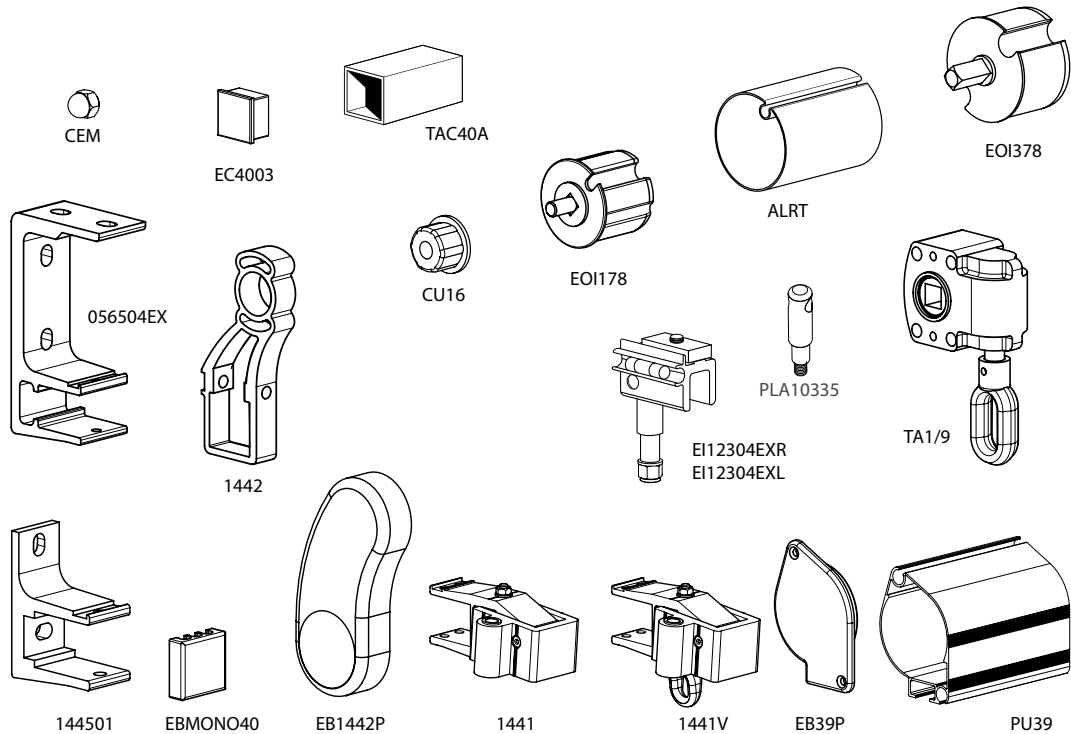
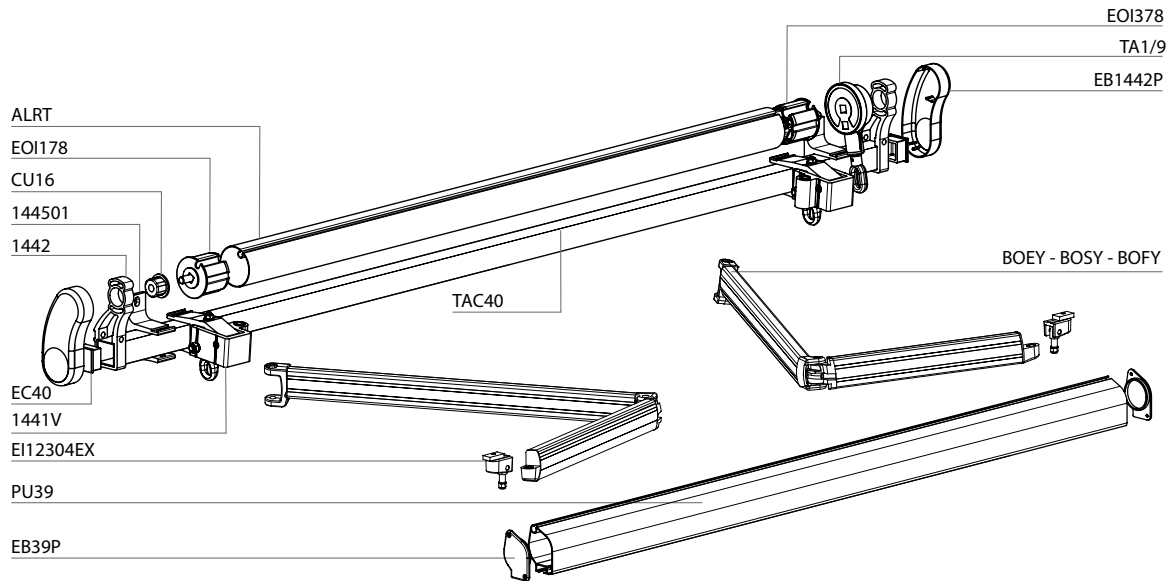

SUN 3000 C Replacement Parts

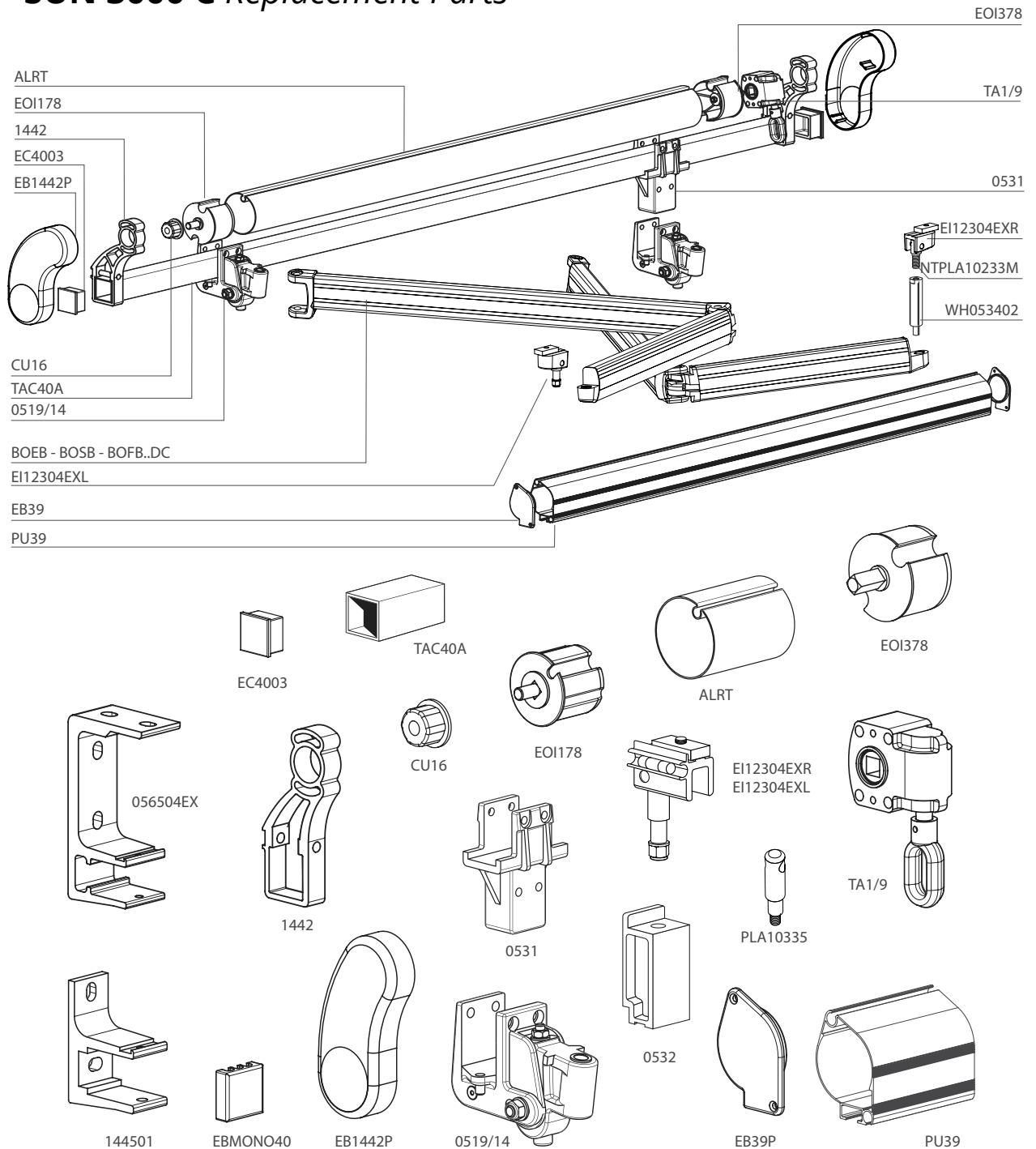

SUN 3000 X Replacement Parts

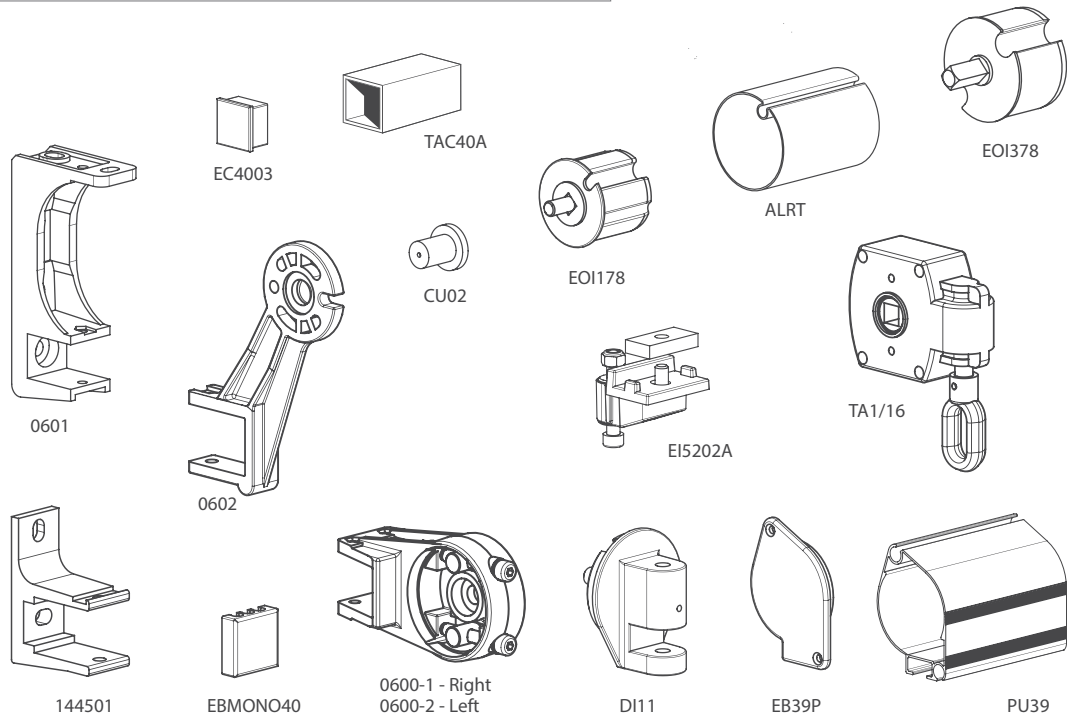
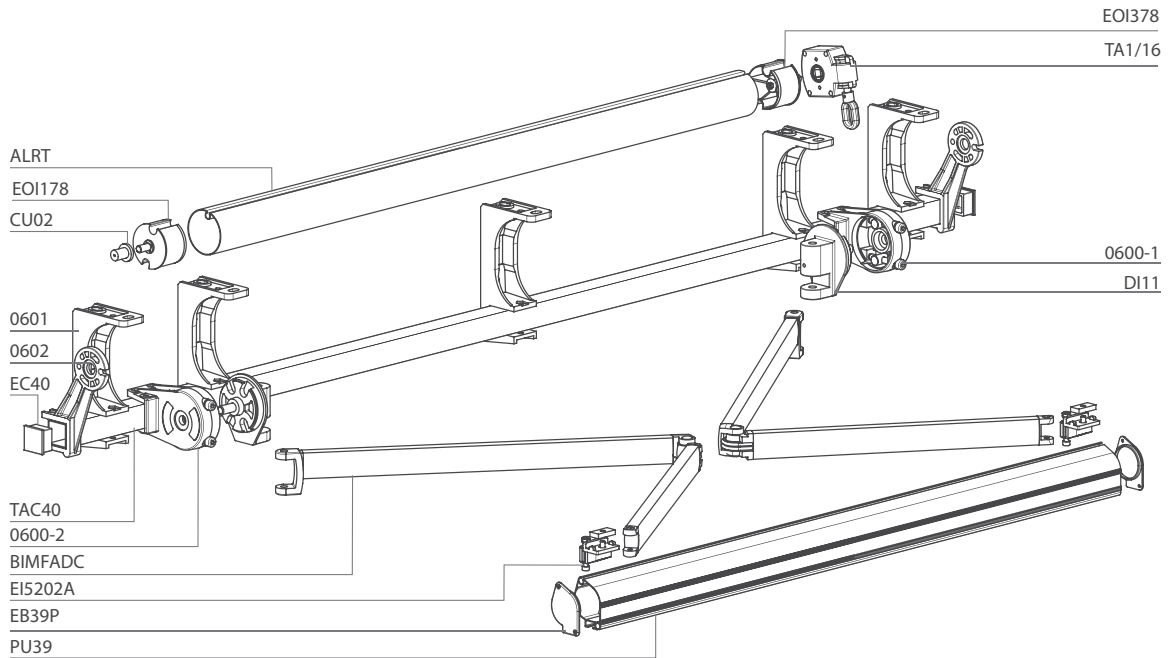

SUN 5000 Replacement Parts

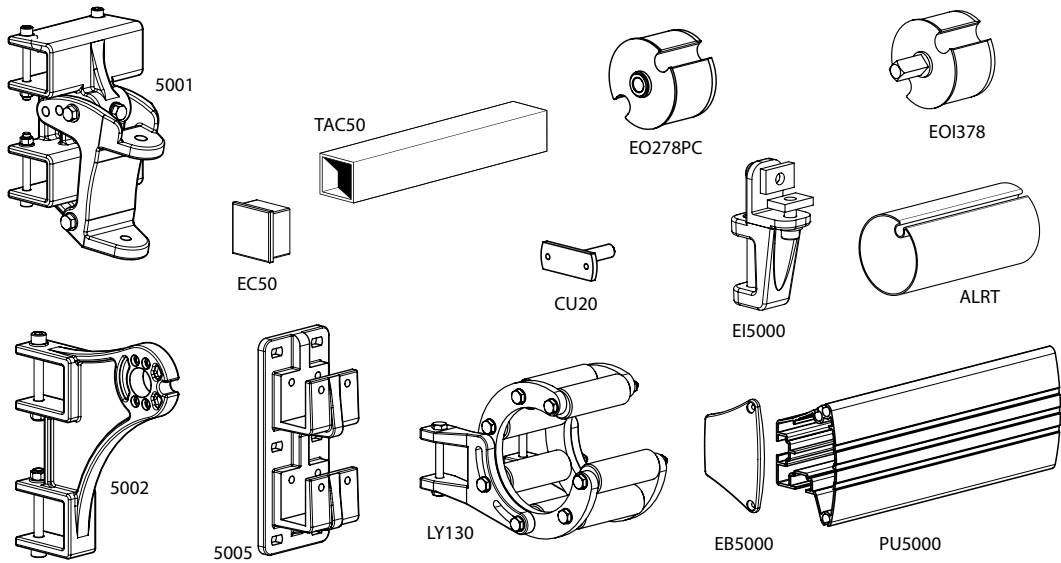
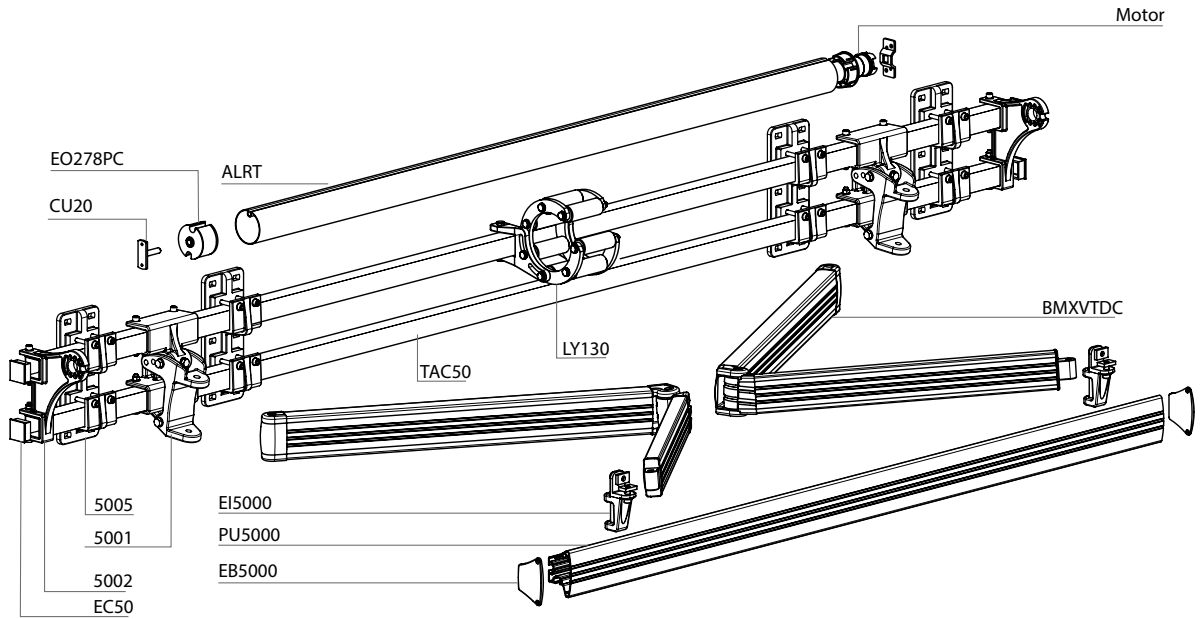

Sun 8000 Window Awnings Replacement Parts

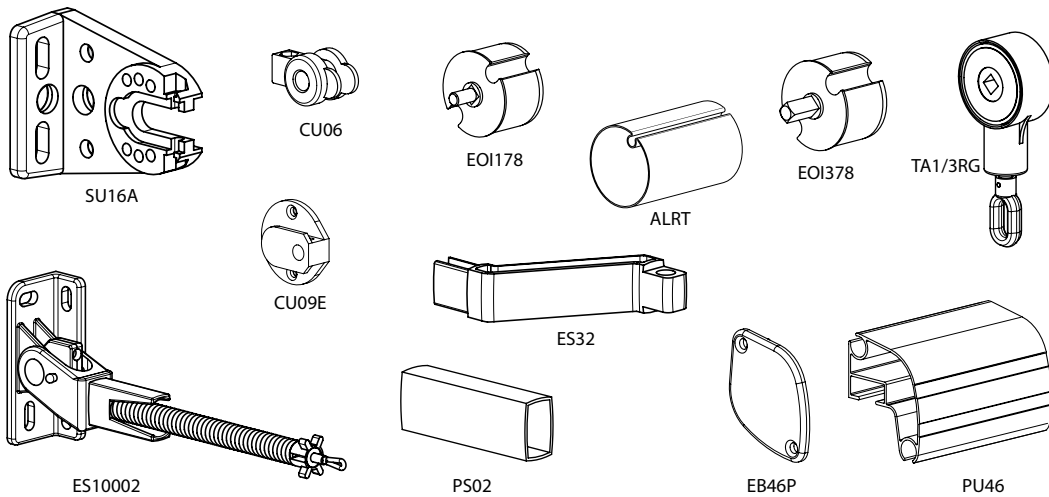
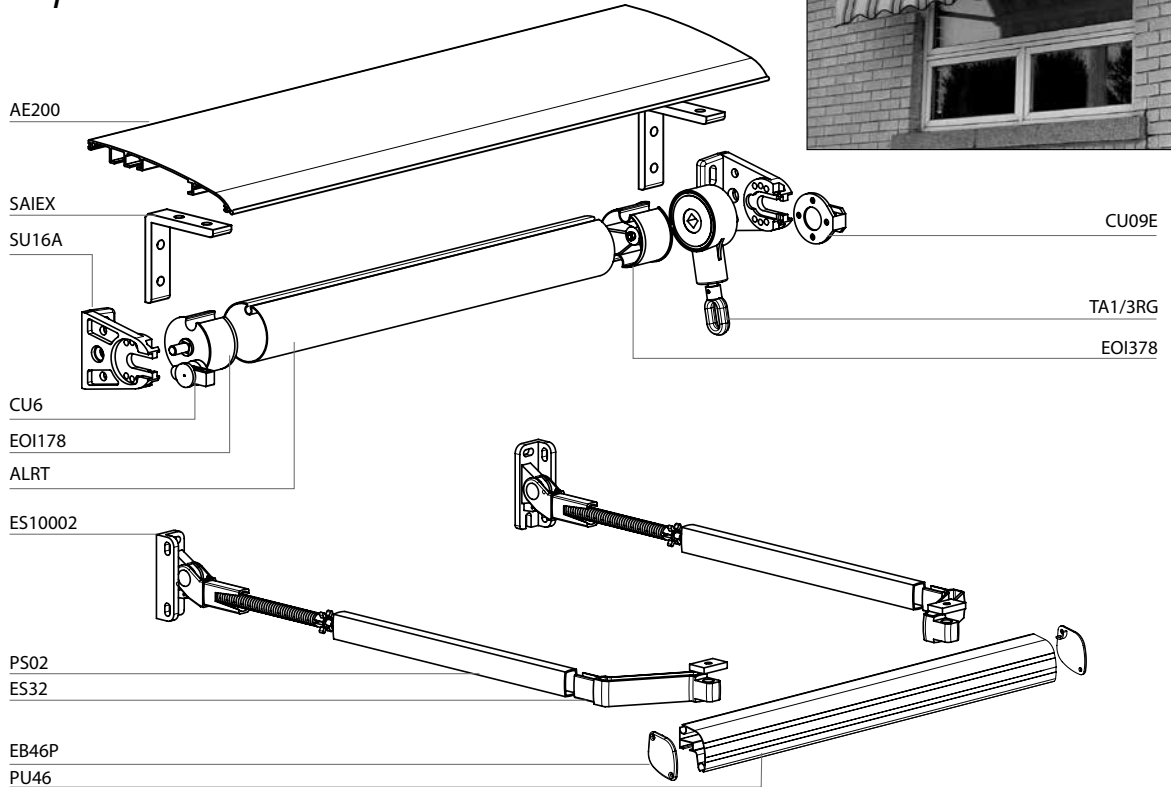

Taking care of the awning system

This product will provide many years of satisfactory service if cared for properly. Routine care is quite simple but certain recommended prefectures should be followed.

- Your awning should be in the retracted position when you're not on the premises. The awning should not be extended during high winds, or rain storms.
- For extended storage periods, make sure your awning is dry and clean before retracting.
- Keep dirt, leaves and other debris from accumulating on the awning surface.



Warning: never use a barbecue grill, any type of patio heater or fireplace under your awning. doing so could result in the fabric burning or melting and could result in personal injury



CAUTION: Never attempt to hang items from any part of the awning, except those accessories that are supplied by the manufacturer.

Sunbrella Fabric limited Warranty

We stand behind our fabrics with a guarantee that's the best in the industry: a 10-year limited warranty for shade and marine fabrics.

This warranty applies to the original purchaser of Sunbrella fabric and protects against Sunbrella fabric becoming unserviceable due to color or strength loss from normal usage and exposure conditions, including sunlight, mildew and atmospheric chemicals. This warranty covers Sunbrella fabric only.

This warranty does not cover normal care and cleaning; damage from misuse or abuse; improper installation; or costs associated with replacement of the fabric, including labor and installation. Glen Raven's liability is expressly limited to this warranty. Glen Raven reserves the right to inspect the fabric submitted for claim. Glen Raven will supply new equivalent fabric to replace the fabric that becomes unserviceable.

Sunsation Limited Warranty

Warranty will cover:

Our Warranty is in effect for a period of 5 years starting from the purchase date. The warranty covers any product defect.

The warranty will only apply on original SUNSATIION™ products.

The warranty will only apply for normal limit use of the products according to the instruction of our engineering department.

Warranty will not cover:

- Damages due to the transportation.
- Damages caused by non-conform assembly.
- Use of non SUNSATIION™ part.
- Damages resulting form snow, rain, hail, wind or any natural disaster.
- Damages resulting form projectiles.
- Damages resulting form non maintenance.
- The dismantling by an unauthorized person.
- Damages due to use of non SUNSATIION™ accessories.

SUNSATIION™ warranty does not cover expenses related to labor, assembly, installation and transportation.

The SUNSATIION™ Awning series are covered with a manufacturers limited warranty for a period of 5 years from the original date of purchase to the initial purchaser from an authorized dealer.

SUNSATIION™ warrants that the SUNSATIION™ awning frame parts & finishes, will be free from any manufacturers defects in material and craftsmanship for a period of 5 years. (For damages to fabric, motors & electronic components, Please ask your dealer for manufacturers warranty details.)

The foregoing warranty shall not be applicable and shall be of no force or effect in the event that the awning system or any part of it is damaged by any act of nature including, but not limited to, hurricanes, gales, tornadoes, wind, snow, sleet, hail, rain, flood, weights or accumulation allowed on awning, fire or any other similar or dissimilar hazard condition, neglect, vandalism, improper use, damages due to care, cleaning or timely maintenance or by normal wear or tear.

Subject to the foregoing terms and conditions, if the awning frame parts (excluding fabric, motors or electronic equipment) are defective in material or workmanship within the applicable limited warranty period set forth herein, SUNSATIION™ will repair or replace at its own option, any defective part. SUNSATIION's obligation is exclusive of labor, and shipping costs. SUNSATIION™ reserves the right to issue a cash refund to the customer in an amount equal to the cost of repair or replacement of any defective part in lieu of any obligation to provide a replacement. SUNSATIION™ reserves the right to inspect the system involved in any claim against warranty. The warranty is null and void if any of the components used to assemble the awning are not original SUNSATIION™ parts.

The foregoing warranty is exclusive and in lieu of all other warranties of quality, written, oral or implied and all other warranties including merchantability or fitness for a particular purpose are hereby disclaimed. In no event shall SUNSATIION™ be liable for any incidentals consequential, indirect or special damages of any nature for defective merchandise and in no instance may damages include loss of profit.

Sunsation Instructions Manual - 2021

For more information please contact
your authorized Sunsation dealer

Sunsation awnings deliver Quality, Comfort, and Class.
Become a Sunsation™ owner today. You'll love the difference.

sunsationawning.com