

Curbside Dining
Product Guide
2021

S&F
SUPPLIES



THE CURB APPEAL

**NYC Becomes Huge Gold Mine of Opportunity
For Printers, Sign Makers, and Awning Builders**

11,000 RESTAURANTS NEED YOU

In the land of opportunity, here's how to find some of the most profitable new landscapes.

Printers, Sign-Makers and Awning Builders: it's time to hit the streets!

New York City's popular "Open Restaurants" program is now permanent, with close to 11,000 participating restaurants on over 350 open streets citywide.

Stability. Durability. Flexibility. Comfort. Appearance. And Compliance with evolving new regulations. NYC dining rules have changed dramatically, but the fundamentals of the industry remain the same. The new permanent outdoor dining enclosures need to be built by the best, with the best in the industry.

For more than 35 years you have trusted us to guide you through all kinds of ups and downs and ins and outs. We are prepared for this moment and are here to help you take advantage of the opportunities that are fast emerging.

Are your customers aware that they might be able to double their capacity due to the new outdoor dining rules? Do all your customers have outdoor dining permits? Do they know that the

permit process takes just a few minutes to complete, and is free?

The government is paving the way for incredible opportunities for restaurant owners with access to public seating areas. And that means tremendous profitable opportunities for you when constructing permanent outdoor dining structures.

Which materials best suit your customers' changing requirements? Aluminum or Steel structures? Fabric, aluminum, acrylic or foam walls? Which roof types will best weather the storms ahead? What are your best options for windows, lighting, and other esthetic details?

Whether you are a printer, sign-maker or awning builder, this product guide has all the elements you need to profit from current changes.

The "Open Restaurants" program gives printers, sign-makers, and awning builders a gold mine with an interactive live map of all establishments currently approved for outdoor seating.

Visit sfsupplies.com/leads
or scan this code to find
your new customers.

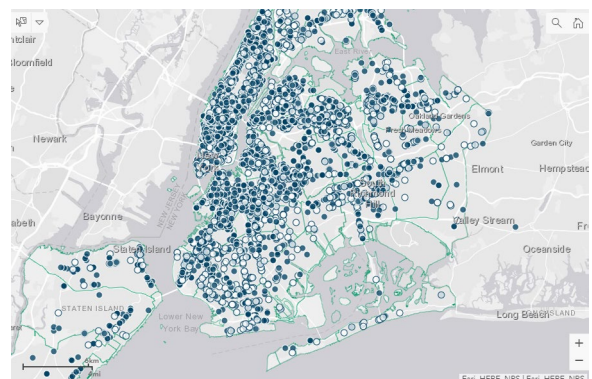



OUTDOOR DINING: NEW YORK CITY REGULATIONS

As of February 3, 2021

NYC announced that the popular **Open Restaurants program** will be made permanent, and restaurants will be permitted to use heating and enclosures, and expand seating to adjacent properties with neighbors' consent. Specific guidance is forthcoming.

The City will work with the City Council to make the regulatory changes necessary to make the program permanent.

Outdoor Dining Area Siting Requirements.

Roadway Seating.

Restaurants must comply with NYC Fire Department Open Flame and other applicable Fire Codes.

Roadway Barriers:.

Create a protective barrier, such as planters or objects of similar size and weight, on all three sides of the seating perimeter that are in the roadway, to separate seating from the travel lane.

Barriers must be at least 18" in width and 30-36" in height (excluding plantings) on all three sides that are in the roadway, to preserve visibility for motorists and provide protection for patrons (see Siting Criteria diagram).

All 18" roadway barriers must be completely filled with soil or sand.

Barriers must have a fully built interior wall and bottom to hold filler material.

Continuous reflector tape must be added along the top outside edges, and snow sticks must be added to the corners of the two barriers facing traffic.

A plastic water-filled barrier in front of the roadway barrier facing oncoming traffic will be required for a majority of restaurants; "high priority" restaurants for whom a water-filled barrier will be required will be identified based on the street's crash rates and traffic volumes, as well as if it's a truck route. These restaurants will be contacted separately to confirm this require-

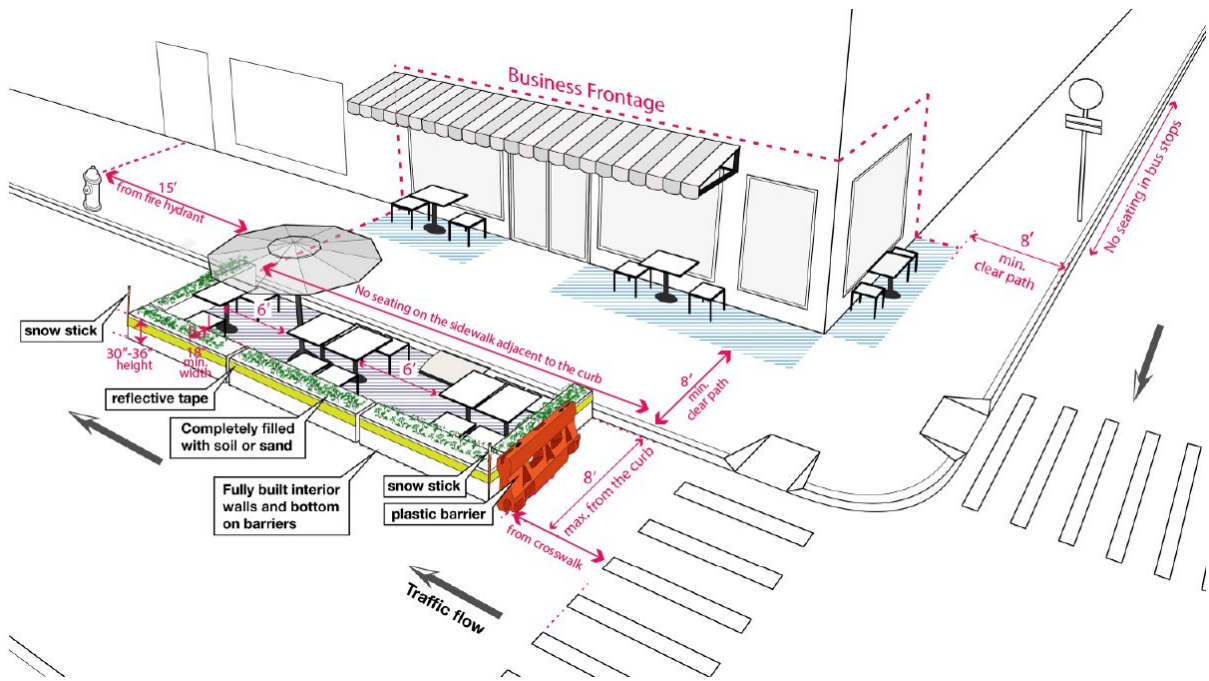

ment applies to them. For all other restaurants, similarly placed water-filled barriers are highly recommended.

Place such barriers directly adjacent to each other (no gaps) and no more than 8' from the curb (see Siting Criteria diagram).

Turn a requirement into an advertisement with reflective vinyl!!



Roadway seating may exceed the length of business frontage into adjacent frontage only with the formal approval from adjacent owner.

Ensure visibility of patrons and barriers at night by clearly marking all barriers with yellow high intensity retro-reflective tape or reflectors (see Siting Criteria diagram).

Provide a ramp for ADA compliance, which can be made of non-permanent materials.

Do not place seating or barriers within 15' of a fire hydrant. Doing so jeopardizes fire safety for your fellow New Yorkers.

Do not place seating or barriers within 8' of a crosswalk, to provide for safe vehicle turns and avoid crowding.

Do not provide any lighting that is blinding to passing traffic.

Do not place seating within a No Stopping Anytime or No Standing Anytime zone, bike lane, bus lane/stop, taxi stand, or Car Share space.

[Exception: For part-time No Stopping or No Standing zones, seating may be placed when those rules are not in effect. Barriers and seating

must be removed from the roadway when No Stopping or No Standing is in effect].

Tents & Enclosures:

Only utilize umbrellas with a weighted base or tents or other shelters, not to exceed 400 SF (square feet) in total or fully enclose the seating area, which follow manufacturers installation instructions to secure the tents properly and safely.

Areas of multiple tents that are combined or are tied to each other cannot exceed 400 SF in total.

New York State outdoor dining guidelines permit installing a temporary or fixed cover (i.e. awning, roof or tent):

Enclosed structures, such as plastic domes, will be allowed for individual parties and must have adequate ventilation to allow for air circulation.

For restaurants with roof structures, the city will be releasing tips and guidance on how to make them secure, as well as quick action to remove snow from roofs, awnings, and tents.

Restaurant owners may:

Leave barriers in place within a metered zone, alternate side parking, or No Parking Anytime zone, provided that that tables and chairs are removed or secured when not in operation.

Visit nyc.gov/openrestaurants or scan this code for the most up-to-date city regulations.



Where seating is authorized along a curb, install a platform behind the required barrier to flush height with curb to facilitate ADA compliance, prevent the curb from becoming a tripping hazard, and allow drainage to underpass seating.

Such platforms shall not block rain water drainage getting to the curb or flowing along the curb.

Such platforms shall not obstruct access to or ventilation of utility covers.

Find an Open Restaurant near you! Search the NYC Open Restaurants map and dashboard at nycopenrestaurants.info. Restaurants appear in this database as soon as they self-certify.

For help completing the application please call the SBS Hotline: 888-SBS-4NYC (888-727-4692). NYC launched this small business hotline to answer the most pressing questions of small business owners as they prepare to re-open. Small Business Advocates and Compliance Advisors will monitor the hotline and have been equipped with the latest guidelines and regulations to share with business owners.

© Copyright 2021 The City of New York.

Article retrieved February 3, 2021.

Use DigiBanner for outdoor dining signage and sidewalk banners.



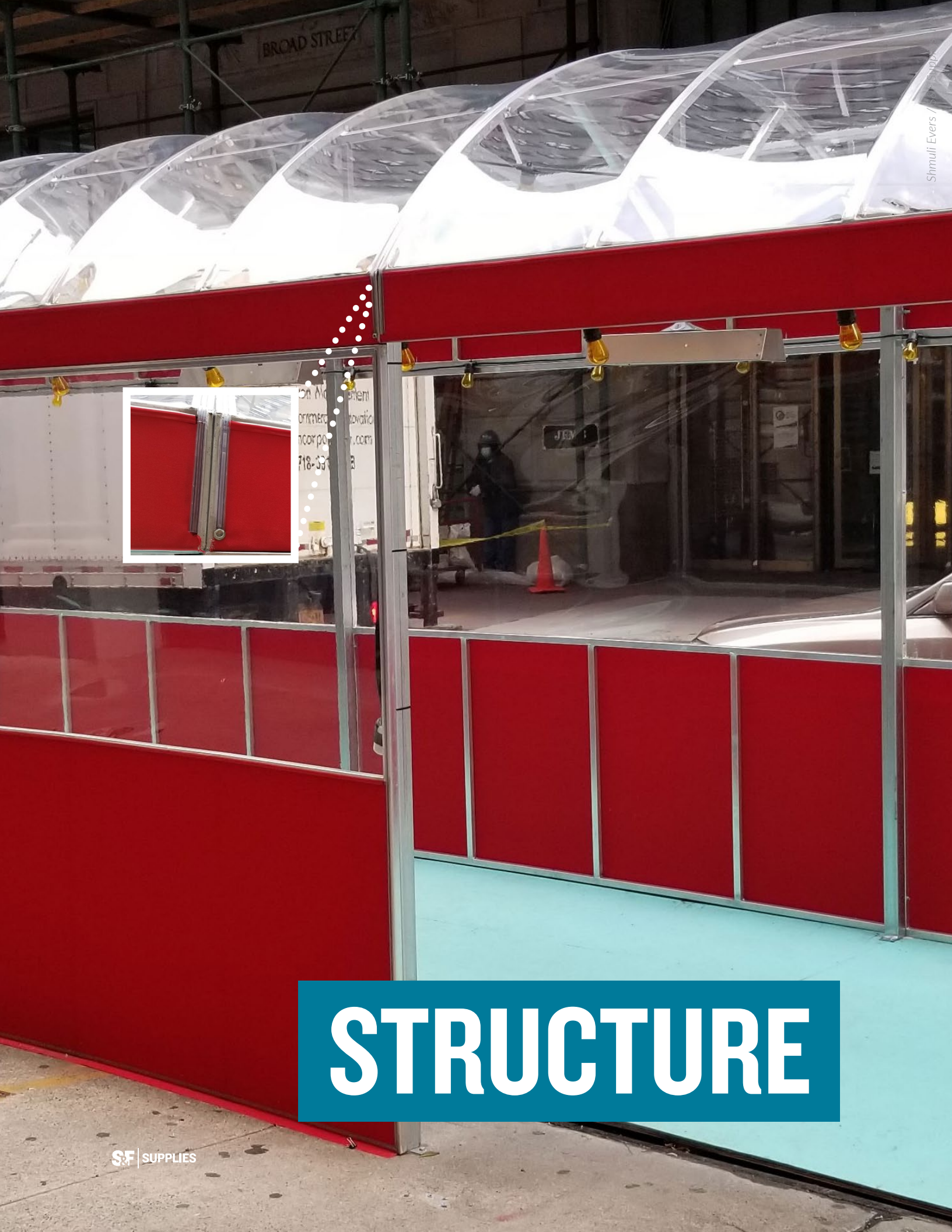

Shmuli Evers / 123RF



STRUCTURE

STRUCTURE: PRODUCTS YOU CAN LEAN ON

Outdoor dining areas require a stable, sturdy and safe structure. Our steel or aluminum tubing provides an excellent frame. Our staple system with vinyl zip strip inserts offers an elegant and discreet finish. Finally, finish the job with your customer's choice of fabric or substrates.

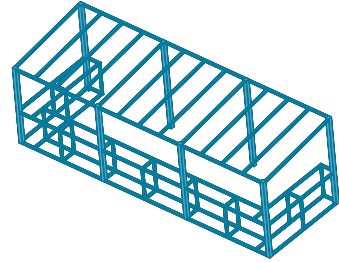

Staple System



Vinyl Inserts

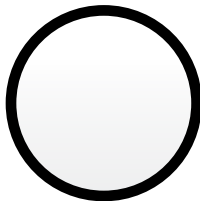

**Round
Tubing**



**Rectangular
Tubing**



**Welding
Rods**

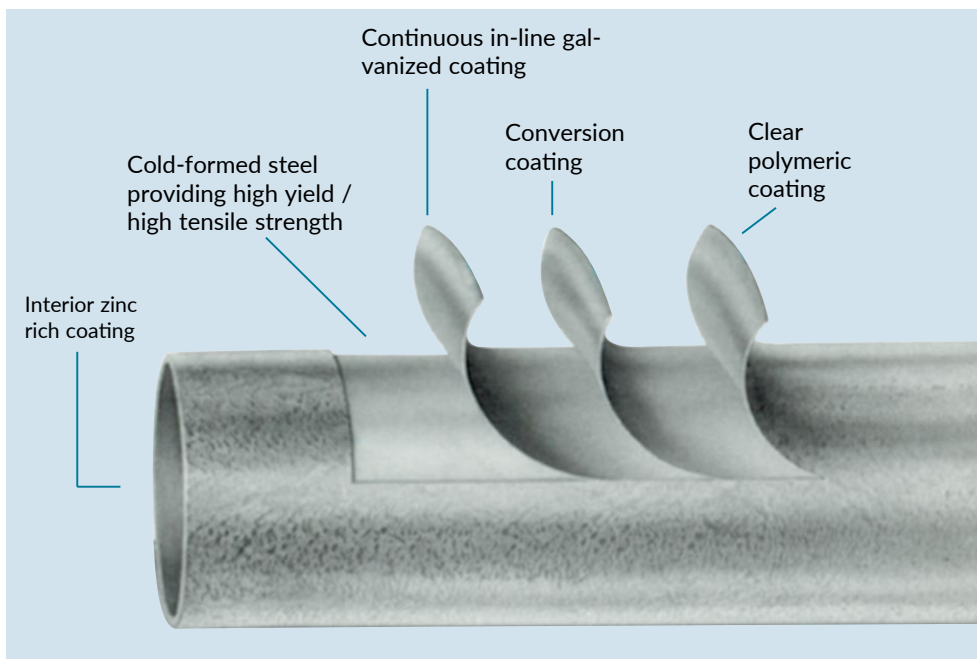
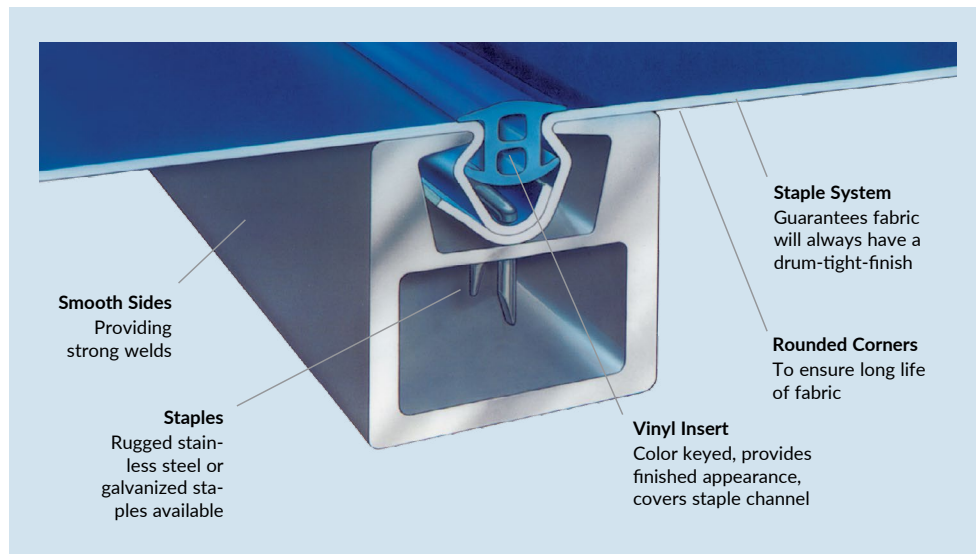

SEAPORT
DISTRICT NYC

SEAPORT
DISTRICT NYC

WALLS

WALLS: LASTING BEAUTY

First impressions count. The walls of your customers' outdoor dining space create the vibe, the buzz. They are what people will notice first and foremost again and again. It is your opportunity to customize the outdoor dining space with a variety of beautiful, weather-spanning options:

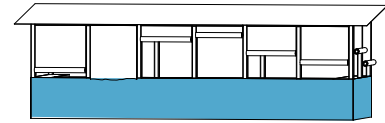

FABRICS



Sunbrella Fabric

Sunbrella® by Glen Raven is considered the standard awning fabric in the industry because of its wide selection of solid colors and sizes, high resistance to fading, and long life span. Sunbrella is a soft, breathable, solution-dyed acrylic that is UV, water, soil and mildew resistant and does not shrink or stretch. Sunbrella offers the strength and durability needed for any awning. Available in 46", 60" & 80" with many solid, striped, and patterned options available. Sunbrella also features a 10 year limited warranty.

SUBSTRATES

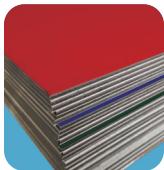

Dura Bond Aluminum Composite

Dura-bond Digital features a specially formulated coating that accepts UV paint for better print results. It is highly durable and easy to install. Dura Bond is available in a variety of custom sizes and colors. Aluminum Composite Dura Bond is corrosion-resistant.



Dura-Cast Acrylic

Acrylic sheets are light weight, resistant most chemicals, feature optical clarity with a high gloss and stability to outdoor exposure. Available in 10 colors and multiple thicknesses.

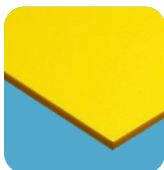

Dura-Foam PVC Sheet

Dura-Foam is a lightweight closed-cell, free foam, rigid PVC sheet. It is colored with a matte finish that is tough and versatile for outdoor dining enclosures. Dura-Foam is available in 12 standard vibrant PVC color sheets, plus black and white, and a variety of thicknesses and sizes to fit most uses. The matte surface is the perfect substrate for screen printing, painting, laminating, vinyl lettering and forming projects. Dura-Foam can be sawed, drilled, bent and fabricated using ordinary (plastic) tools and fasteners. Dura-foam is manufactured to be used for interior and limited exterior applications.



ROOF

THE OUTDOOR DINING ROOF: A TOP PRIORITY

When it comes to outdoor dining in New York and New Jersey, choosing a roof with sufficient strength is literally a top priority. Heavy snow, wind, and rain are a fact of life in our area. Another important consideration is whether the outdoor dining space needs to accommodate sunlight or block it. In either event, your customers will be eternally grateful to you when the roof that you recommend proves its worth over time and through even the most adverse weather conditions. As their customers continue to enjoy a safe, dining experience during and after a storm under the protection of the roof you have recommended, imagine how that will boost your customers' business – and yours!

Also consider a Sunsation™ retractable awning (see back cover).

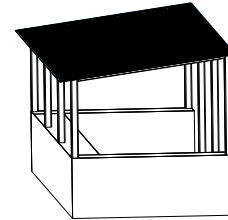
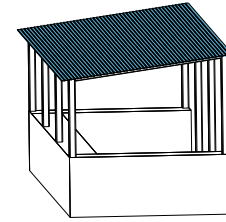

Aluminum Step Down

Aluminum step down is a coated aluminum sheeting, like the traditional aluminum used in awnings. Unlike canvas, aluminum increases reflective light into your space. Aluminum is the perfect low maintenance year-round choice and is designed to withstand the elements indefinitely. It is also environmentally friendly. Most colors available in 31" x 12' and 31" x 24' and .2" gauge.



Polycarbonate

Convenient design allows rain to clean the top of the canopy. Available in solid and textured finish. Polycarbonate is sold in sheets and rolls. Polycarbonate sheets are maintenance free and long-lasting.



WINDOWS

WINDOWS: A ROOM WITH A VIEW

In an outdoor dining space, windows play several key roles. The first is to provide protection from unwelcome weather conditions like wind or rain. At the same time, windows ensure enhanced energy efficiency in both warm and cold weather. Our state-of-the-art outdoor dining windows achieve all this and more in fixed or flexible options.

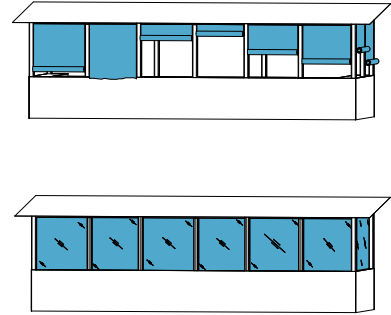

CLEAR PLASTIC

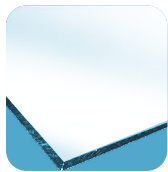

Clear Polycarbonate

Polycarbonate is tough, 200 times stronger than glass. It has high clarity and high temperature resistance. It is also easy to tint and shade, for a more private dining experience.



Dura-Cast Clear Acrylic

Acrylic sheets are lightweight, resistant to most chemicals, and made for optical clarity and stability to outdoor exposure. Can be used with LED, mercury lamps and neon tubes. Double-sided use for matte and glossy.

SOFT WINDOWS/DOORS



Bring the indoors outside with clear, vinyl drop curtains that protect against the wind, rain, sun and cold. Provides UV light protection. Moisture resistance prevents mold and mildew. These durable curtains are tear and rip resistant. Attach with grommets or hook and loop fasteners. Available in various thickness and widths from 8" to 54".



U. V. Clear Side Curtain Vinyl



Grommets



3M Hook and Loop

DECORATIVE LIGHTING

DECORATIVE LIGHTING: THE GLOW OF SUCCESS

Ambiance is so important in outdoor dining spaces. And decorative lighting is the easiest and most efficient way to generate that glow! Our options include flexible and fixed LED lighting and special neon-style lighting strips. Any of these selections are sure to generate glowing reviews in your customers' outdoor dining space.



GreenleafLED Brilliant/Primo Modules

Brilliant modules are bright and energy efficient, allowing you to use fewer modules and power supplies for each installment. The 160° angle allows for even light dispersal without hot spots. Available in white (10,000K), red, green, and blue. Available in 6,500K and 7,200K, Primo modules are a constant current upgrade. Fully stretched to 1.5 modules/foot, Primo modules contain a unique cable containment feature for tighter installations.



EcoLED RGB LED Module

EcoLED RGB module series brings together quality illumination, reliability, and convenience in one complete package under one roof. This module can produce many different colors when used with the RGB controller. Easy to use, just push a button to select any of the seven programmed color changing modes or select all modes to display in sequence. Can also be set to any color with the stop mode.

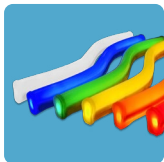

SloanLED FlexiBRITE Flexible LED Tubing

FlexiBRITE is field bendable making it easy to create an endless array of profiles, contours, and patterns on the fly. Ideal for exterior and interior lighting applications such as sign perimeters, letters, symbols, accent stripes, borders, and open face channel letters. Classic colors retain hue in daytime. Can be custom-cut in the field.

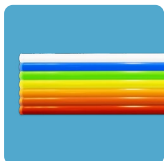

SloanLED LEDStripe Tubing

For 20 years LEDStripe® has added lighting elegance and distinction to buildings worldwide. This patented LED based rigid tubing system, with its large profile and long runs, has become the border tube system of choice for many retail, restaurant, and lodging chains. Available in many color options. Daytime color when non illuminated. LEDStripe is made of high impact acrylic — UV stable, hydrocarbon insensitive, and non fading. It can be factory bent to minimum 12 inch radius and can be cut in the field. Conforms to UL 48 requirements



BRANDING

BRANDING: THE NAME OF THE GAME

What's more important than promoting your customers' brand? It's the proverbial "Name of the Game." The whole beginning and end of all you do for your customers. What are the best ways to promote your customers' brand? Cut vinyl. Cut letters. Painted. HDU. You name it. We've got it. Plus, as always, you know you can count on us to strategize or improvise and generally assist in every way possible to help you promote your customers' brand.



Avery Vinyl

Avery Dennison® calendered films are premium quality, flexible, solid color vinyl films available in a number of finish and color options, designed for use in a wide range of sign making applications. This product is ideal for a variety of intermediate term outdoor projects. Outstanding durability and outdoor performance. Easy cutting & weeding. Good UV, temperature, humidity, and salt-spray resistance.



Duna HDU Corafoam

High density CORAFOAM® (HDU) is an innovative polyurethane substrate used for a variety of applications in the signage, modeling, aerospace, composite, architectural and design industries. Its grain-free consistency and broad range of densities provides solutions to craftsmen and engineers alike. Its resistance to atmospheric agents, most solvents, and moisture, make CORAFOAM® polyurethane an ideal replacement for wood and other signage materials.



PVC Substrate

PVC substrate is a common option for indoor and outdoor signage. Its smooth surface is perfect for ink adhesion and uniformity. It comes in various sizes, colors and thickness.



1-Shot Lettering Enamel Paint

Lettering Enamels are oil based, superior quality high gloss enamels for interior or exterior use on metal, glass, wood, masonite, MDO and enamel receptive banner & vinyl materials. Intended for sign writing on store fronts, vehicles and wherever fine lettering work is desired. They have outstanding hiding, durability and excellent resistance to sagging. Superior flow characteristics assure the virtual absence of brush marks and provide a clean, sharp edge.

DIGI NOVA

**FREE
DESIGN
BUNDLE:**



Go to sfsupplies.com/downloads or scan this code to download the free S&F Outdoor Dining Bundle including 21 multi-purpose vinyl templates and a marketing template.

**S&F
SUPPLIES**



DIGI PERF

WRAP AND ROLL!

BEAUTIFUL DESIGN AND CURBSIDE PRIVACY WITH

digijet

DIGI ETCHMARK

sunsation™
RETRACTABLE AWNINGS

We've got you
COVERED

UPGRADE OPTIONS AVAILABLE

Remote Control

App Control

LED Lighting

Motorized
Awning System

Climate-Controlled
System

Hood

www.sunsationawning.com

Shop A-frames
at S&F Supplies

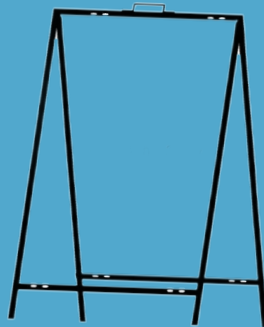

sfsupplies.com