

**PRICE ADJUSTMENT**

EFFECTIVE APRIL 1, 2018

Mill Finish Extrusions & Kits.....+6%

Pre-Painted Extrusions & Kits.....+6%

All Accessories and Components.....+6%

Please contact SignComp Customer Service for assistance

Post & Panels (Powder Coat Finish)**RTS - Post & Panel System**

Flagmount

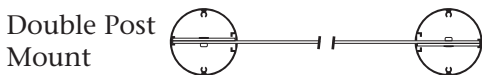
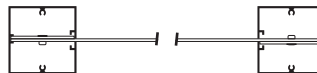
Double Post Mount
(2 Post Kits Required)Double Post Mount (3-1/4" Square Post shown)
(2 Post Kits Required)*Note: All mounting provisions to be provided by fabricator.***3-1/4" Round Post****3-1/4" Square Post****Available in powder coated gloss white and gloss black finishes, 96" and 144" posts.**

Each 96" and 144" RTS Post Kit includes:

- 48" slot to accommodate up to a 48" high, 1/8" or 3mm panel.
- One (1) adjustable, 48" Post Filler to accommodate a panel less than 48" high.
- One (1) 1/8" Post Cap with two (2) countersunk cap screws.
- One (1) adjustable 96" Panel Trim for 1/8" or 3mm hollow core panel material.
- Two (2) 6" Locking Strips.
- One (1) 96" or 144" powder coated gloss white or gloss black RTS Post.

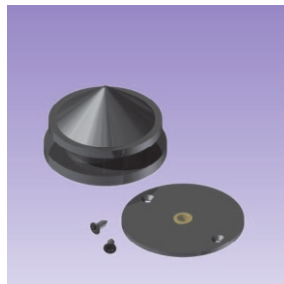
NOTE: Face material not included.**List Price Per Single Post Kit (2 post kits required for double post mount)****Optional Accessories**Ball Finial Kit
w/Square CapWhite - Part #RTS-5700F WHT
Black - Part #RTS-5700F BLKBall Finial Kit
w/Round CapWhite - Part #RTS-5701F WHT
Black - Part #RTS-5701F BLKTapered Ring Finial Kit
w/Round CapWhite - Part #RTS-5703F WHT
Black - Part #RTS-5703F BLKTapered Ring Finial Kit
w/Square CapWhite - Part #RTS-5702F WHT
Black - Part #RTS-5702F BLK**Finial Kit Includes:** Finial with 1/4" threaded stud, Cap with 1/4" threaded insert and two (2) Cap Screws.**Price per
Post Kit****Square Post**

96" Post

Part #RTS-1015-8' WHT

Part #RTS-1015-8' BLK

\$116.71 each

144" Post

Part #RTS-1015-12' WHT

Part #RTS-1015-12' BLK

\$167.92 each**Round Post**

96" Post

Part #RTS-1017-8' WHT

Part #RTS-1017-8' BLK

\$107.19 each

144" Post

Part #RTS-1017-12' WHT

Part #RTS-1017-12' BLK

\$153.63 each**Price per Finial****Ball Finial****Ball Finial with Square Cap**

(Cap Screws and Threaded Insert Included)

Part #RTS-5700F WHT

Part #RTS-5700F BLK

\$37.76 each**Ball Finial with Round Cap**

(Cap Screws and Threaded Insert Included)

Part #RTS-5701F WHT

Part #RTS-5701F BLK

\$37.76 each**NOTE: Caps are slightly oversized.****Tapered Ring Finial****Tapered Ring Finial
with Square Cap**

(Cap Screws and Threaded Insert Included)

Part #RTS-5702F WHT

Part #RTS-5702F BLK

\$37.76 each**Tapered Ring Finial
with Round Cap**

(Cap Screws and Threaded Insert Included)

Part #RTS-5703F WHT

Part #RTS-5703F BLK

\$37.76 each**NOTE: Caps are slightly oversized.**



PRICE ADJUSTMENT

EFFECTIVE APRIL 1, 2018

Mill Finish Extrusions & Kits.....+6%
 Pre-Painted Extrusions & Kits.....+6%
 All Accessories and Components.....+6%

Please contact SignComp Customer Service for assistance

Post & Panels (Pre-painted)

Series 2/3 Panel Adaptors

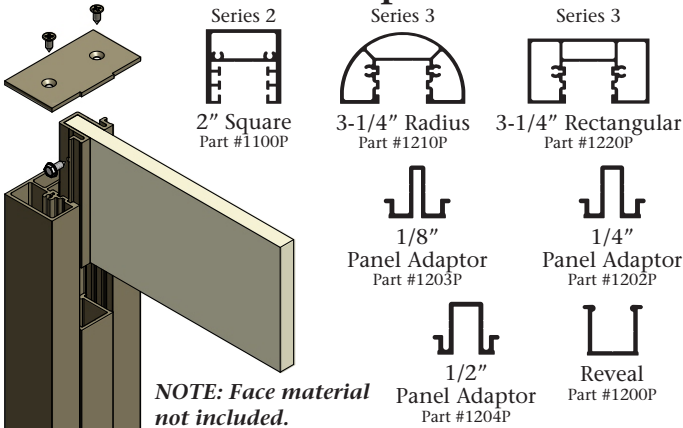

NOTE: Face material not included.

Features & Benefits:

- Pre-painted dark bronze exterior finish.
- Simple to assemble.
- The 1/8", 1/4" and 1/2" Panel Adaptor can be used with any rigid or solid core composite 1/8", 1/4" or 1/2" sheet stock.

Panel Adaptor Kit Includes:

- Two (2) 95-5/8" cut to size posts.
- Two (2) slightly oversized caps with screws.
- Full Panel Adaptor or cut to size Panel Adaptor with Series 2/3 Reveal "below the panel filler" included.
- Screws for panel assembly.

NOTE: The "below the panel filler" is cut to fit 6" below grade.

Price per Kit

Series 2, 2" Square Post

Two (2) 95-5/8" posts
 & caps - \$248.00
 For 9', 10', & 11' post lengths -
 Add \$18.00 per ft. per post
 Two (2) 143-5/8" posts
 & caps - \$359.00

Series 3, 3-1/4" Posts
Radius & Rectangular

Two (2) 95-5/8" posts
 & caps - \$268.00
 For 9', 10', & 11' post lengths -
 Add \$20.00 per ft. per post
 Two (2) 143-5/8" posts
 & caps - \$393.00

Series 2

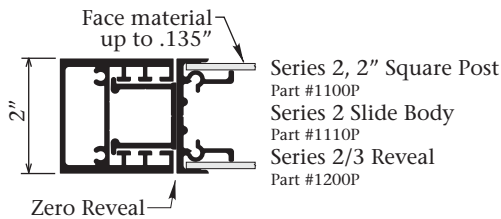
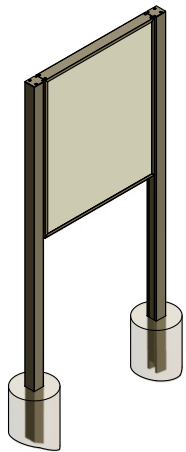

Series 2 Kit Includes:

- Two (2) 95-5/8" Series 2, 2" Square Posts.
- Two (2) slightly oversized caps with screws.
- Four (4) pieces cut to size and mitered Series 2 Slide Body.
- Two (2) pieces cut to size Series 2/3 Reveal and "below the panel filler".
- All hardware required for assembly.

NOTE: Face material not included.

Features & Benefits:

- Pre-painted dark bronze exterior finish.
- Simple to assemble.
- Series 2/3 Reveal can be set in the zero, 3/8" or 3/4" position.

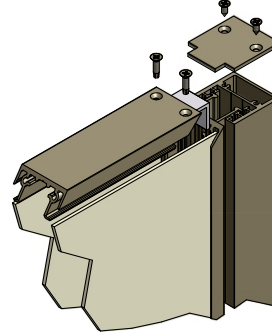

Price per Kit

Series 2

H" x W"	List
12 x 24	\$322
24 x 24	336
24 x 36	349
36 x 36	358
36 x 48	372
36 x 60	384
36 x 72	395
48 x 48	384
48 x 60	395
48 x 72	407

Additional Sizes and Full Lengths Available

Series 3

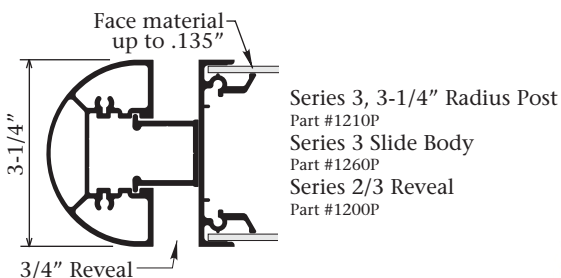
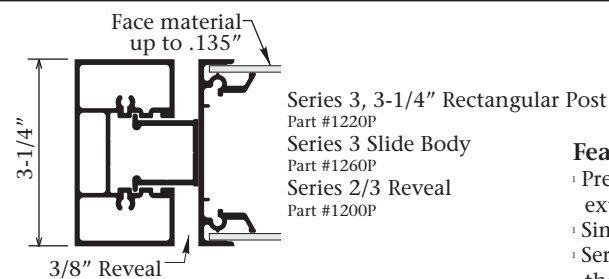
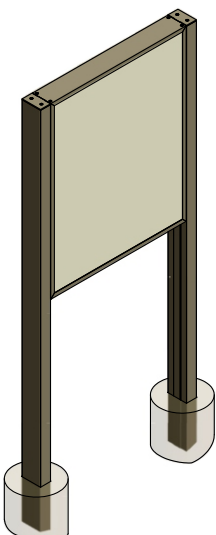

Series 3 Kit Includes:

- Two (2) 95-5/8" Series 3, 3-1/4" Rectangular or Radius Posts.
- Two (2) slightly oversized caps with screws.
- Four (4) pieces cut to size and mitered Series 3 Slide Body.
- Two (2) pieces cut to size Series 2/3 Reveal and "below the panel filler".

Features & Benefits:

- Pre-painted dark bronze exterior finish.
- Simple to assemble.
- Series 2/3 Reveal can be set in the zero, 3/8" or 3/4" position.

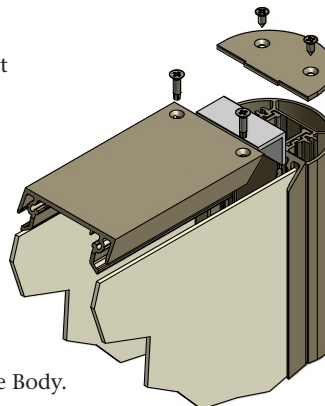

NOTE: Face material not included.

Price per Kit

Series 3

H" x W"	List
24 x 24	\$400
24 x 36	419
24 x 48	437
36 x 36	437
36 x 48	453
36 x 60	470
36 x 72	487
48 x 48	470
48 x 60	487
48 x 72	505

Additional Sizes and Full Lengths Available